





Most of our organizers are designed for base cabinets but we also have innovative products that are unique to any other category like our notorious sink front trays, fashionable rattan basket and stunning heavy-duty chrome mixer lift. These popular accessories are designed with the same superior quality and tremendous versatility adherent throughout the Rev-A-Shelf product line.

SINK & BASE ACCESSORIES

563 SERIES TOWEL HOLDER AND PULLOUT TOWEL BAR

563-32 Towel Holder

- Fastens to any cabinet door
- Stores up to three dish towels
- Available in white or chrome

563-47 Pullout Towel Bar

- Prongs slide-out of the cabinet 12"
- Stores up to three dish towels
- Available in white or chrome
- Features universal brackets for right or left hand mounting



Includes: *Spacers for
Face Frame Installation*

PRODUCT #	DESCRIPTION	DIMENSIONS	FINISH	SET PER CTN	WHT PER CARTON	SUGGESTED LIST PRICE
Towel Holders (Individual Pack)						
563-32	Towel Holder	12¾" (324 mm)W x 3½" (89 mm)D x 6½" (165 mm)H	White	1	1 lb.	\$5.35
563-32 C	Towel Holder	12¾" (324 mm)W x 3½" (89 mm)D x 6½" (165 mm)H	Chrome	1	1 lb.	\$5.80
563-47	3 Prong Towel Bar	5" (127 mm)W x 17¾" (451 mm)D x 1¼" (32 mm)H	White	1	2 lb.	\$27.85
563-47 C	3 Prong Towel Bar	5" (127 mm)W x 17¾" (451 mm)D x 1¼" (32 mm)H	Chrome	1	2 lb.	\$30.75

CONTAINS:

563-32 (1) Towel holder w/ mounting screws. 563-47 (1) Pullout Towel Bar, 3 prong model with 12" (305 mm) extension, face frame spacers, and mounting screws.

563 SERIES PULLOUT TOWEL BAR

- Stores up to two towels
- Features a ball-bearing slide
- Easy four-screw installation
- Left or right hand mounting capabilities



PRODUCT #	DESCRIPTION	DIMENSIONS	FINISH	SET PER CTN	WHT PER CARTON	SUGGESTED LIST PRICE
Towel Holder (Individual Pack)						
563-51-C	2 Prong Towel Bar	3⅞" (99 mm)W x 12⅞" (327 mm)D x 1½" (38 mm)H	Chrome	1	2.6 lb.	\$20.45

CONTAINS:

(1) Pullout Towel Bar, 2 prong model, mounting screws.



Product Video



SBDT SERIES

DRIP TRAY

- Protects the bottom of your cabinet from spills
- Funnels excessive water out of the front of your cabinet
- Designed for installation in NEW 30", 36" and 40" sink base cabinet construction
- Can be cut down to fit a 27", 33" or 39" cabinets

TRAY CAPACITY

SBDT-2730	1.46 QT.
SBDT-3336	1.77 QT.
SBDT-3942	2.15 QT.

SINK AND BASE
ACCESSORIES

SEE PAGE 189 FOR VANITY VERSION



Recommended for new cabinetry. Product may be difficult to install after sink and countertop are installed



S: Metallic Silver, A: Almond

PRODUCT #	DESCRIPTION	DIMENSIONS	MINIMUM TRIM	FINISH	SET PER CTN	WHT PER CARTON	SUGGESTED LIST PRICE
Drip Tray (Individual Pack)							
SBDT-2730-A-1	Drip Tray	28½" (724 mm)W x 23¼" (591 mm)D x ¾" (19 mm)H	25½" (648 mm) x 21½" (546 mm)	Almond	1	4 lb.	\$52.50
SBDT-2730-S-1	Drip Tray	28½" (724 mm)W x 23¼" (591 mm)D x ¾" (19 mm)H	25½" (648 mm) x 21½" (546 mm)	Metallic silver	1	4 lb.	\$57.85
SBDT-3336-A-1	Drip Tray	34½" (877 mm)W x 23¼" (591 mm)D x ¾" (19 mm)H	31½" (800 mm) x 21½" (546 mm)	Almond	1	5 lb.	\$58.45
SBDT-3336-S-1	Drip Tray	34½" (877 mm)W x 23¼" (591 mm)D x ¾" (19 mm)H	31½" (800 mm) x 21½" (546 mm)	Metallic silver	1	5 lb.	\$64.40
SBDT-3942-A-1	Drip Tray	40½" (1029 mm)W x 23¼" (591 mm)D x ¾" (19 mm)H	37½" (953 mm) x 21½" (546 mm)	Almond	1	8 lb.	\$64.40
SBDT-3942-S-1	Drip Tray	40½" (1029 mm)W x 23¼" (591 mm)D x ¾" (19 mm)H	37½" (953 mm) x 21½" (546 mm)	Metallic silver	1	8 lb.	\$70.75
Drip Tray (Bulk Pack)							
SBDT-2730-A-12	Drip Tray	28½" (724 mm)W x 23¼" (591 mm)D x ¾" (19 mm)H	25½" (648 mm) x 21½" (546 mm)	Almond	12	30 lb.	\$45.10 ea.
SBDT-2730-S-12	Drip Tray	28½" (724 mm)W x 23¼" (591 mm)D x ¾" (19 mm)H	25½" (648 mm) x 21½" (546 mm)	Metallic silver	12	30 lb.	\$49.60 ea.
SBDT-3336-A-12	Drip Tray	34½" (877 mm)W x 23¼" (591 mm)D x ¾" (19 mm)H	31½" (800 mm) x 21½" (546 mm)	Almond	12	48 lb.	\$50.05 ea.
SBDT-3336-S-12	Drip Tray	34½" (877 mm)W x 23¼" (591 mm)D x ¾" (19 mm)H	31½" (800 mm) x 21½" (546 mm)	Metallic silver	12	48 lb.	\$55.10 ea.
SBDT-3942-A-12	Drip Tray	40½" (1029 mm)W x 23¼" (591 mm)D x ¾" (19 mm)H	37½" (953 mm) x 21½" (546 mm)	Almond	12	47 lb.	\$55.10 ea.
SBDT-3942-S-12	Drip Tray	40½" (1029 mm)W x 23¼" (591 mm)D x ¾" (19 mm)H	37½" (953 mm) x 21½" (546 mm)	Metallic silver	12	47 lb.	\$60.45 ea.

RL SERIES

CABINET SECURITY–
REV•A•LOCK®

- Powerful magnetic locks that can attach to wood, glass, metal, and particleboard cabinets for a guaranteed safeguard from curious little hands
- To open, hold the magnetic key against the cabinet door to disengage the lock
- Features an unlocking device that disables the lock

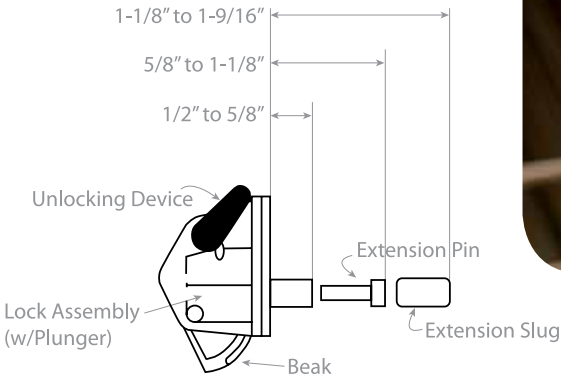

The lock will install on thickness of 1/2" (13 mm) to 1 1/8" (40 mm) and operate through wood, glass, metal and particle board

Additional colors* available via special order!
Contact your sales person for more information!
*minimum order of 500



PRODUCT #	DESCRIPTION	FINISH	SET PER CTN	WHT PER CARTON	SUGGESTED LIST PRICE
Rev-A-Lock Cabinet Security (Components)					
RAL-101-1	Starter Set (5 Locks & 2 Keys)	White Polymer	1	1 lb.	\$57.85
RL-201-1	Lock Assembly	White Polymer	25	3 lb.	\$9.55 ea.
RL-202-1	Magnetic Key	White Polymer	25	2 lb.	\$13.35 ea.

NOTES: Components Bulk Packed: All locks include unlocking device and extension slug. Bulk packaging minimum (25) sets per carton. Starter Set is individually packed in UPS carton.

6230 SERIES

DOOR STORAGE TRAY SET

- Available in two or five tray sets
- Available in three lengths
- Easy to install with screw-in clips
- Option to mount to 24" or 58" standards with tray clips (sold separately)
- Sets are available in white or almond

SINK AND BASE ACCESSORIES



6232-14-11-52



6232-20-11-52

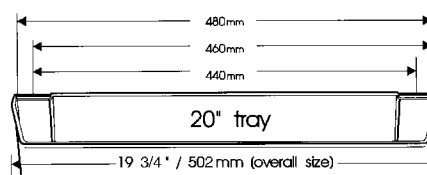
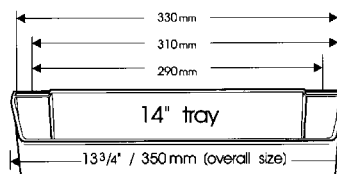
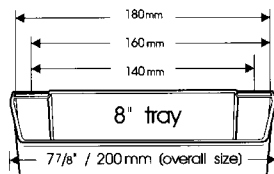

• These 3 dimensions show the range of hole spacings available for tray mounting.

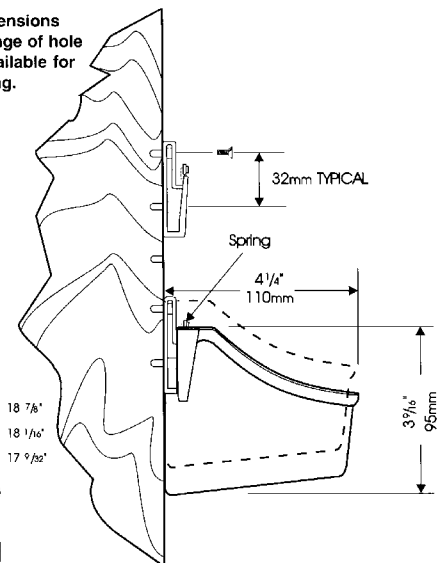

PRODUCT #	DESCRIPTION	DIMENSIONS	FINISH	SET PER CTN	WHT PER CARTON	SUGGESTED LIST PRICE
Two Tray Set with Clips (Individual Pack)						
6232-08-**-52	Tray with Screw-In Clips	7 ⁷ / ₈ " (200 mm)W x 4 ¹ / ₄ " (110 mm)D x 3 ³ / ₁₆ " (95 mm)H	Polymer	1	1 lb.	\$23.35/set
6232-14-**-52	Tray with Screw-In Clips	13 ³ / ₄ " (350 mm)W x 4 ¹ / ₄ " (110 mm)D x 3 ³ / ₁₆ " (95 mm)H	Polymer	1	2 lb.	\$25.25/set
6232-20-**-52	Tray with Screw-In Clips	19 ³ / ₄ " (502 mm)W x 4 ¹ / ₄ " (110 mm)D x 3 ³ / ₁₆ " (95 mm)H	Polymer	1	3 lb.	\$31.75/set
Five Tray Set with Clips (Individual Pack)						
6235-08-**-52	Tray with Screw-In Clips	7 ⁷ / ₈ " (200 mm)W x 4 ¹ / ₄ " (110 mm)D x 3 ³ / ₁₆ " (95 mm)H	Polymer	1	2 lb.	\$55.55/set
6235-14-**-52	Tray with Screw-In Clips	13 ³ / ₄ " (350 mm)W x 4 ¹ / ₄ " (110 mm)D x 3 ³ / ₁₆ " (95 mm)H	Polymer	1	4 lb.	\$60.20/set
6235-20-**-52	Tray with Screw-In Clips	19 ³ / ₄ " (502 mm)W x 4 ¹ / ₄ " (110 mm)D x 3 ³ / ₁₆ " (95 mm)H	Polymer	1	5 lb.	\$71.80/set

NOTES: Our Door Storage trays are packaged with Screw-In Clips instead of Tray Clips. The Tray Clips will be packaged with the mounting standards to complete the set package. (Mounting Standards must be ordered separately.) ** Available colors: 11 White, 15 Almond

596 SERIES

U-SHAPED
TRAY DIVIDER

- Use one or more to create custom storage space
- Suitable for wall or base cabinets
- Heavy-duty chrome wire
- Simple four screw installation

SINK AND BASE
ACCESSORIES

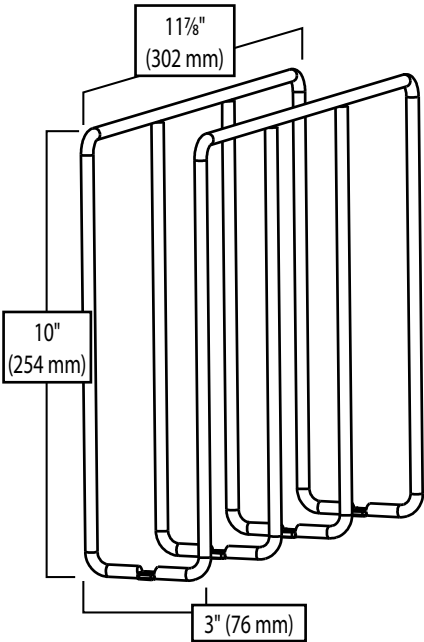

PRODUCT #	DESCRIPTION	DIMENSIONS	FINISH	SET PER CTN	WHT PER CARTON	SUGGESTED LIST PRICE
U-Shaped Tray Divider (Individual Pack)						
596-10CR-52	U-Shaped Tray Divider	3" (76 mm)W x 11 7/8" (302 mm)D x 10" (254 mm)H	Chrome	1	2.5 lb.	\$20.60

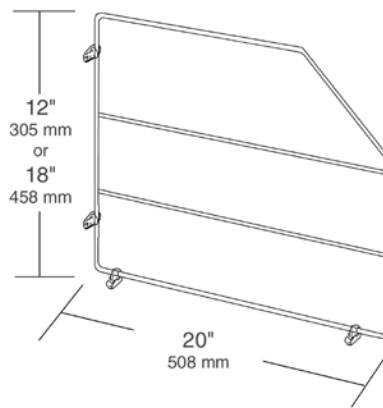

597 SERIES

TRAY DIVIDERS WITH CLIPS

- Available in white or chrome
- Available in 12" and 18" height
- Includes four screw-in clips and fasteners

PRODUCT #	DESCRIPTION	DIMENSIONS	FINISH	SET PER CTN	WHT PER CARTON	SUGGESTED LIST PRICE
Tray Divider (White Wire) (Individual Pack)						
597-12-52	Tray Divider with Clips	¾" (19 mm)W x 20" (508 mm)D x 12" (305 mm)H	White Wire	1 pc.	2 lb.	\$9.85
597-18-52	Tray Divider with Clips	¾" (19 mm)W x 20" (508 mm)D x 18" (458 mm)H	White Wire	1 pc.	2 lb.	\$10.75
Tray Divider (White Wire) (Bulk Pack)						
597-12-10	Tray Divider with Clips	¾" (19 mm)W x 20" (508 mm)D x 12" (305 mm)H	White Wire	10 pc.	12 lb.	\$7.55 ea.
597-18-10	Tray Divider with Clips	¾" (19 mm)W x 20" (508 mm)D x 18" (458 mm)H	White Wire	10 pc.	14 lb.	\$8.25 ea.
Tray Divider (Chrome Wire) (Individual Pack)						
597-12CR-52	Tray Divider with Clips	¾" (19 mm)W x 20" (508 mm)D x 12" (305 mm)H	Chrome Wire	1 pc.	2 lb.	\$13.50
597-18CR-52	Tray Divider with Clips	¾" (19 mm)W x 20" (508 mm)D x 18" (458 mm)H	Chrome Wire	1 pc.	2 lb.	\$14.20
Tray Divider (Chrome Wire) (Bulk Pack)						
597-12CR-10	Tray Divider with Clips	¾" (19 mm)W x 20" (508 mm)D x 12" (305 mm)H	Chrome Wire	10 pc.	12 lb.	\$10.90 ea.
597-18CR-10	Tray Divider with Clips	¾" (19 mm)W x 20" (508 mm)D x 18" (458 mm)H	Chrome Wire	10 pc.	14 lb.	\$11.75 ea.

CONTAINS: 597-12/18-52 (1) tray dividers with four (4) screw-in clips and fasteners 597-12/18-10 (10) Tray Dividers per size with (4) screw-in clips and fasteners per set.
597-12/18CR-52 (1) tray divider with (4) screw-in clips and fasteners 597-12/18CR-10 (10) Tray Dividers per size with (4) screw-in clips and fasteners per set.

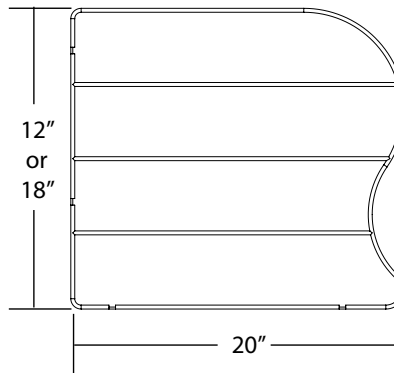

LD-597 SERIES

CHROME TRAY DIVIDER

- Heavy-Duty chrome wire
- Available in 12" and 18" height
- Screw directly into cabinet back and bottom

PRODUCT #	DESCRIPTION	DIMENSIONS	FINISH	SET PER CTN	WHT PER CARTON	SUGGESTED LIST PRICE
Chrome Tray Divider (Individual Pack)						
LD-597-12CR-1	12" LD Chrome Tray Divider	20" (508 mm) W x 12" (205 mm) W	Chrome	1	1.7 lb.	\$13.50
LD-597-18CR-1	18" LD Chrome Tray Divider	20" (508 mm) W x 18" (458 mm) W	Chrome	1	1.8 lb.	\$14.20
Chrome Tray Divider (Bulk Pack)						
LD-597-12CR-10	12" LD Chrome Tray Divider	20" (508 mm) W x 12" (205 mm) W	Chrome	10	10.6 lb.	\$10.90 ea.
LD-597-18CR-10	18" LD Chrome Tray Divider	20" (508 mm) W x 18" (458 mm) W	Chrome	10	16.95 lb.	\$11.75 ea.

LD-6591 SERIES

SINK FRONT (TIP-OUT) TRAYS

- Three widths (22", 24" and 30-1/2")
- Available in white or almond
- Sold as bulk trays or individually with 45° pivot hinges



PRODUCT #	DESCRIPTION	DIMENSIONS	FINISH	SET PER CTN	WHT PER CARTON	SUGGESTED LIST PRICE
False Front Tip-Out Tray System (Std./Acc.) (Individual Pack)						
LD-6591-22-**-1	Deluxe Tip-Out Tray W/1 Pr 45° Hinges	22" (559 mm)W x 2 7/8" (54 mm)D x 3 15/16" (97 mm)H	Polymer Tray	1	1.9 lb.	\$18.40
LD-6591-24-**-1	Deluxe Tip-Out Tray W/1 Pr 45° Hinges	24" (610 mm)W x 2 7/8" (54 mm)D x 3 15/16" (97 mm)H	Polymer Tray	1	2 lb.	\$19.85
LD-6591-30-**-1	Deluxe Tip-Out Tray W/1 Pr 45° Hinges	30" (762 mm)W x 2 7/8" (54 mm)D x 3 15/16" (97 mm)H	Polymer Tray	1	2.3 lb.	\$23.80
False Front Tip-Out Trays Only (Bulk Pack)						
LD-6591-22-**-10	Deluxe Tip-Out Trays Only	22" (559 mm)W x 2 7/8" (54 mm)D x 3 15/16" (97 mm)H	Polymer Tray	10	19 lb.	\$10.30 ea.
LD-6591-24-**-10	Deluxe Tip-Out Trays Only	24" (610 mm)W x 2 7/8" (54 mm)D x 3 15/16" (97 mm)H	Polymer Tray	10	20 lb.	\$10.45 ea.
LD-6591-30-**-10	Deluxe Tip-Out Trays Only	30" (762 mm)W x 2 7/8" (54 mm)D x 3 15/16" (97 mm)H	Polymer Tray	10	23 lb.	\$12.90 ea.

65** SERIES

36" SINK FRONT (TIP-OUT) TRAYS

- Available in 36" or 72" sizes
- Can be trimmed to the desired length
- Includes molded polymer end caps
- Key-shaped holes for easy removal and cleaning
- Can be used as a tip-out tray or a spice rack
- Available in white or almond

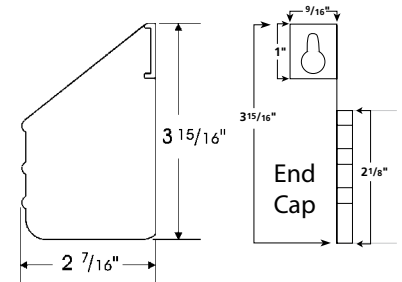
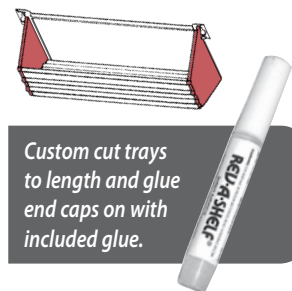

PRODUCT #	DESCRIPTION	DIMENSIONS	FINISH	SET PER CTN	WHT PER CARTON	SUGGESTED LIST PRICE
36" Tray with Hinges and End Caps (Individual Pack)						
6551-36-**-52	1 Tray - 2 Pair Hinges & End Caps	36" (914 mm)W x 2 7/8" (62 mm)D x 3 15/16" (100 mm)H	Polymer Trays	1	1.7 lb.	\$42.20
6551-36-**-50	1 Tray - 1 Pair Hinges & End Caps	36" (914 mm)W x 2 7/8" (62 mm)D x 3 15/16" (100 mm)H	Polymer Trays	1	1.7 lb.	\$28.85
6551-36-**-ETH	1 Tray - 1 Pair Hinges & End Caps	36" (914 mm)W x 2 7/8" (62 mm)D x 3 15/16" (100 mm)H	Polymer Trays	1	3 lb.	\$35.40
Bulk Pack by Components						
6552-97-**-4	Hinges, End Caps, Inst. & Adhesive			40 Pr.	11 lb.	\$13.35 pr.
6552-ETH-**-10	Hinges, End Caps, Inst. & Adhesive			10 Pr.	3.9 lb.	\$15.65 pr.
6571-36-**-4	Trays ONLY	36" (914 mm)W x 2 7/8" (62 mm)D x 3 15/16" (100 mm)H	Polymer Trays	20	21 lb.	\$13.50 ea.
6571-72-**-4	Trays ONLY	72" (1829 mm)W x 2 7/8" (62 mm)D x 3 15/16" (100 mm)H	Polymer Trays	20	36 lb.	\$32.20 ea.
Components for Tip-Out or Spice Tray Applications						
ST-97-**-4	End Caps, Screws			40 Pr.	4 lb.	\$7.55 pr.
6571-60-52	Tube of Adhesive	2 Gram		1	.1 lb.	\$5.95
6571-61-52	Bottle of Adhesive	1 Ounce		1	.1 lb.	\$30.90

NOTES: 6552 Series End cap/Hinge sets are individually poly bagged, bulk packed.

Sink Front Trays can also be installed into Vanity Sink Base Cabinets! ** Available colors: 11 White, 15 Almond

65** SERIES

SINK FRONT (TIP-OUT) TRAYS

- Includes one conventional open tray, one accessory tray with ring holder and soap dish
- Two pairs of Self-Holdin® hinges included
- Construction of high-impact polystyrene
- Available in 11" or 14" sizes in white or almond
- Trays can be purchased individually without hinges in a bulk 40-tray pack

SINK AND BASE
ACCESSORIES



6572 ALMOND

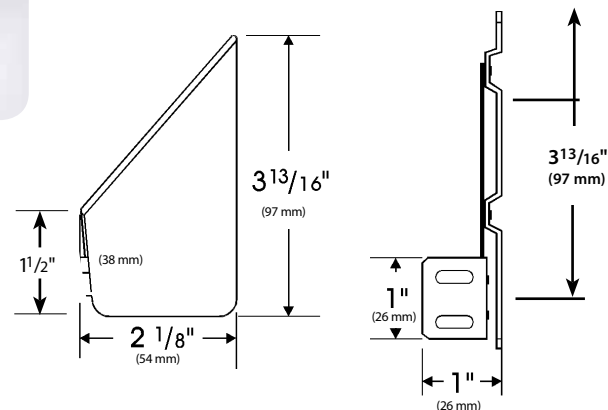

PRODUCT #	DESCRIPTION	DIMENSIONS	FINISH	SET PER CTN	WHT PER CARTON	SUGGESTED LIST PRICE
False Front Tip-Out Tray System (Std./Acc.) (Individual Pack)						
6572-11-**-52	Std./Acc Trays with Hinges	11" (280 mm)W x 2 1/8" (54 mm)D x 3 13/16" (97 mm)H	Polymer Trays	1	2 lb.	\$28.00
6572-14-**-52	Std./Acc Trays with Hinges	14" (356 mm)W x 2 1/8" (54 mm)D x 3 13/16" (97 mm)H	Polymer Trays	1	2 lb.	\$28.30
False Front Tip-Out Tray System (Std./Acc.) (Bulk Pack)						
6572-11-**-4	Std./Acc Trays with Hinges	11" (280 mm)W x 2 1/8" (54 mm)D x 3 13/16" (97 mm)H	Polymer Trays	20	26 lb.	\$25.80 ea.
6572-14-**-4	Std./Acc Trays with Hinges	14" (356 mm)W x 2 1/8" (54 mm)D x 3 13/16" (97 mm)H	Polymer Trays	20	30 lb.	\$25.95 ea.
False Front Tip-Out Trays (Bulk Pack)						
6581-11-**-4	Standard Trays	11" (280 mm)W x 2 1/8" (54 mm)D x 3 13/16" (97 mm)H	Polymer Tray	40 Trays	12 lb.	\$5.95 ea.
6581-14-**-4	Standard Trays	14" (356 mm)W x 2 1/8" (54 mm)D x 3 13/16" (97 mm)H	Polymer Tray	40 Trays	15 lb.	\$5.95 ea.
6591-11-**-4	Accessory Trays	11" (280 mm)W x 2 1/8" (54 mm)D x 3 13/16" (97 mm)H	Polymer Tray	40 Trays	13 lb.	\$5.95 ea.
6591-14-**-4	Accessory Trays	14" (356 mm)W x 2 1/8" (54 mm)D x 3 13/16" (97 mm)H	Polymer Tray	40 Trays	16 lb.	\$5.95 ea.

CONTAINS: 6572 Series: Each set has (1) Standard and (1) Accessory tray and 2-pair of Self-Holdin® hinges. 6581 Series: 40 STANDARD molded polymer sink front trays.

6591 Series: 40 ACCESSORY molded polymer trays with ring holder and soap dish.

NOTES: For use with 2 fronts on sink base cabinet. ** Available colors: 11 White, 15 Almond

654* SERIES SLIM SERIES SINK FRONT (TIP-OUT) TRAYS

- Perfect for hiding sponges and scouring pads out of sight
- Slim Series is designed to accommodate minimum clearance openings
- Available in 11" or 14" solid or extruded tray kits
- Available in white or almond

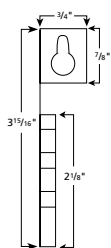

END CAP

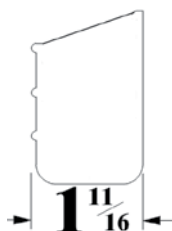

SLIM SERIES

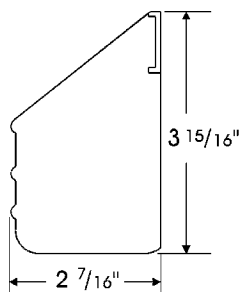

6551 SERIES

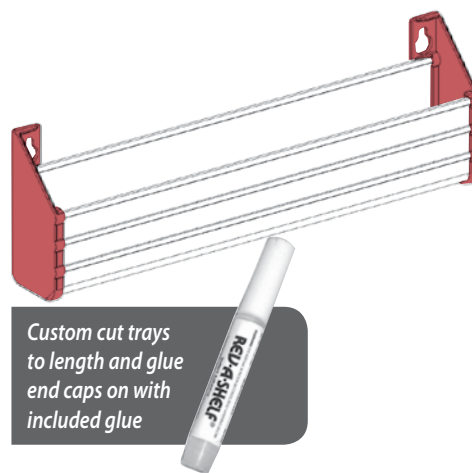

PRODUCT #	DESCRIPTION	DIMENSIONS	FINISH	SET PER CTN	WHT PER CARTON	SUGGESTED LIST PRICE
2 Trays with 2 Pr. of Hinges (Individual Pack)						
6542-11-**-52	Trays with Hinges	11" (280 mm)W x 1 1/16" (42 mm)D x 3 1/16" (100 mm)H	Polymer Trays	1	2 lb.	\$31.05
6542-14-**-52	Trays with Hinges	14" (360 mm)W x 1 1/16" (42 mm)D x 3 1/16" (100 mm)H	Polymer Trays	1	2 lb.	\$31.20
20 - 2 Tray Sets with 40 Pr. of Hinges (Bulk Pack)						
6542-11-**-4	Trays with Hinges	11" (280 mm)W x 1 1/16" (42 mm)D x 3 1/16" (100 mm)H	Polymer Trays	20	26 lb.	\$30.15 ea.
6542-14-**-4	Trays with Hinges	14" (360 mm)W x 1 1/16" (42 mm)D x 3 1/16" (100 mm)H	Polymer Trays	20	26 lb.	\$30.45 ea.
Kits and Components						
6541-36-**-52	Tray, End Caps, 2 pr. Hinges	36" (914 mm)W x 1 1/16" (42 mm)D x 3 1/16" (100 mm)H	Polymer Trays	1	1.5 lb.	\$39.90
6541-36-**-50	Tray, End Caps, 1 pr. Hinges	36" (914 mm)W x 1 1/16" (42 mm)D x 3 1/16" (100 mm)H	Polymer Trays	1	1.5 lb.	\$27.70
6541-36-**-ETH	Tray, End Caps, 1 pr. Hinges	36" (914 mm)W x 1 1/16" (42 mm)D x 3 1/16" (100 mm)H	Polymer Trays	1	1.5 lb.	\$33.05
Bulk Components						
6541-36-**-4	Tray ONLY	36" (914 mm)W x 1 1/16" (42 mm)D x 3 1/16" (100 mm)H	Polymer Trays	20	19 lb.	\$15.35 ea.
6542-97-**-4	Hinges & End Caps	For 20 - Two Tray Sets		40	18 lb.	\$15.25 ea.
6542-ETH-**-10	Hinges & End Caps			10	4.0 lb.	\$19.45 ea.

NOTES:

Sink Front Trays can also be installed into Vanity Sink Base cabinets.

** Available colors: 11 White, 15 Almond

65**/6581 SERIES

(TIP-OUT) TRAY SETS W/SOFT-CLOSE

- Easy to install soft-close hinge
- Designed for use with all of our Rev-A-Shelf Tip-Out trays
- Eliminates slamming
- 50° opening
- Stiffening ribs provide extra stability and eliminate side play

See page 67 for bulk hinges

SINK AND BASE
ACCESSORIES



FITS INSET CABINETS

FITS INSET CABINETS

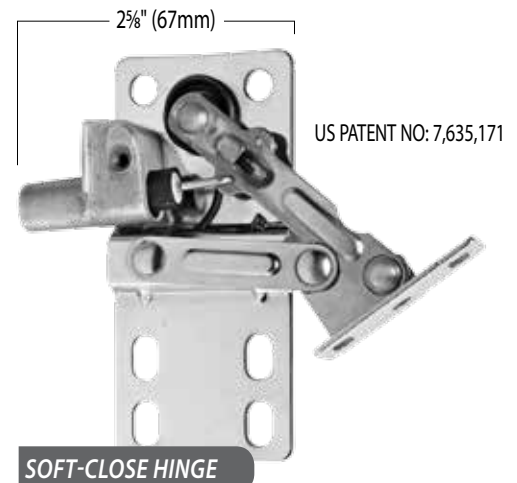

PRODUCT #	DESCRIPTION	DIMENSIONS	FINISH	SET PER CTN	WHT PER CARTON	SUGGESTED LIST PRICE
Trays with Soft-close Hinges (Individual Pack)						
6541-36SC-11-50	36" Slim Series Tray, Soft-Close Hinge, End Cap	36" (914 mm)W x 1 1/8" (42 mm)D x 3 15/16" (100 mm)H	White	1	1.5 lb.	\$36.55
6541-36SC-15-50	36" Slim Series Tray, Soft-Close Hinge, End Cap	36" (914 mm)W x 1 1/8" (42 mm)D x 3 15/16" (100 mm)H	Almond	1	1.5 lb.	\$36.55
Trays with Soft-close Hinges (Individual Pack)						
6551-36SC-11-50	36" Tray, Soft-Close Hinge, End Cap	36" (914 mm)W x 2 7/8" (62 mm)D x 3 15/16" (100 mm)H	White	1	1.7 lb.	\$36.55
6551-36SC-15-50	36" Tray, Soft-Close Hinge, End Cap	36" (914 mm)W x 2 7/8" (62 mm)D x 3 15/16" (100 mm)H	Almond	1	1.7 lb.	\$36.55
Trays with Soft-close Hinges (Individual Pack)						
6581-25SC-52	25" Stainless Steel Tray w/Soft-close Hinge	25" (635 mm)W x 2 1/8" (54 mm)D x 3" (77 mm)H	Chrome	1	2 lb.	\$48.45
6581-28SC-52	28" Stainless Steel Tray w/Soft-close Hinge	28" (711 mm)W x 2 1/8" (54 mm)D x 3" (77 mm)H	Chrome	1	2 lb.	\$49.90
6581-31SC-52	31" Stainless Steel Tray w/Soft-close Hinge	31" (788 mm)W x 2 1/8" (54 mm)D x 3" (77 mm)H	Chrome	1	2 lb.	\$52.20

NOTES: To order **INDIVIDUAL** packed trays with (1) pair of hinges. Order 6581-**-52 (Call for pricing). To order stainless steel trays with **TABS** [3/4" (83 mm)D] order 6591-**-6 (Call for pricing).
PATENT PENDING

65** SERIES

STAINLESS STEEL (TIP-OUT) TRAY SETS

- Slim Series is designed to accommodate minimum clearance openings for large sink applications
- Available in 10 sizes ranging from 10" to 31" in length
- Can be ordered with Rev-A-Shelf's patented Self-Holdin® hinges
- Custom logo or trade name stamping also available with 80 tray minimum (plus die cost)

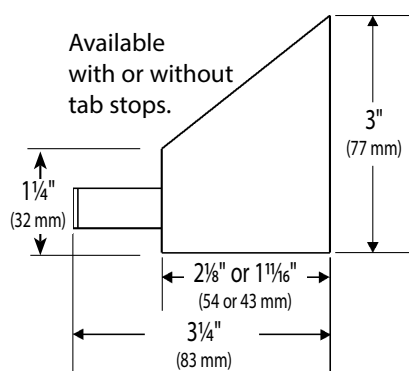

**CUSTOM
STAMPING**
of logo or trade
name is available
on all Stainless
Tip-Outs upon
request. 80 tray
minimum
+ die cost

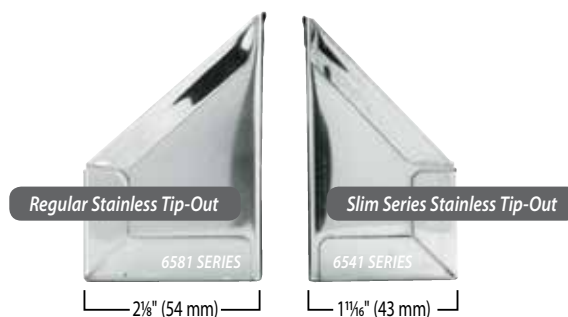

PRODUCT #	DESCRIPTION	DIMENSIONS	FINISH	SET PER CTN	WHT PER CARTON	SUGGESTED LIST PRICE
20 Trays 20 Pair of Hinges (Bulk Pack)						
65*1-10-4	10" Stainless Steel Tip-Out Tray	10" (254 mm)W x See Image for Depth x 3" (77 mm)H	Stainless Steel	20	15 lb.	\$25.40 ea.
65*1-11-4	11-1/4" Stainless Steel Tip-Out Tray	11 1/4" (286 mm)W x See Image for Depth x 3" (77 mm)H	Stainless Steel	20	17 lb.	\$25.80 ea.
65*1-13-4	13" Stainless Steel Tip-Out Tray	13" (330 mm)W x See Image for Depth x 3" (77 mm)H	Stainless Steel	20	19 lb.	\$25.95 ea.
65*1-14-4	14-1/4" Stainless Steel Tip-Out Tray	14 1/4" (362 mm)W x See Image for Depth x 3" (77 mm)H	Stainless Steel	20	20 lb.	\$26.40 ea.
65*1-16-4	16" Stainless Steel Tip-Out Tray	16" (407 mm)W x See Image for Depth x 3" (77 mm)H	Stainless Steel	20	21 lb.	\$26.70 ea.
65*1-19-4	19" Stainless Steel Tip-Out Tray	19" (483 mm)W x See Image for Depth x 3" (77 mm)H	Stainless Steel	20	23 lb.	\$27.55 ea.
65*1-22-4	22" Stainless Steel Tip-Out Tray	22" (559 mm)W x See Image for Depth x 3" (77 mm)H	Stainless Steel	20	25 lb.	\$28.85 ea.
65*1-25-4	25" Stainless Steel Tip-Out Tray	25" (635 mm)W x See Image for Depth x 3" (77 mm)H	Stainless Steel	20	27 lb.	\$30.30 ea.
65*1-28-4	28" Stainless Steel Tip-Out Tray	28" (711 mm)W x See Image for Depth x 3" (77 mm)H	Stainless Steel	20	29 lb.	\$30.90 ea.
65*1-31-4	31" Stainless Steel Tip-Out Tray	31" (788 mm)W x See Image for Depth x 3" (77 mm)H	Stainless Steel	20	31 lb.	\$31.60 ea.
20 Trays Only (Bulk Pack)						
65*1-10-5	10" Stainless Steel Tip-Out Tray	10" (254 mm)W x See Image for Depth x 3" (77 mm)H	Stainless Steel	20	9 lb.	\$16.25 ea.
65*1-11-5	11-1/4" Stainless Steel Tip-Out Tray	11 1/4" (286 mm)W x See Image for Depth x 3" (77 mm)H	Stainless Steel	20	10 lb.	\$16.55 ea.
65*1-13-5	13" Stainless Steel Tip-Out Tray	13" (330 mm)W x See Image for Depth x 3" (77 mm)H	Stainless Steel	20	11 lb.	\$16.80 ea.
65*1-14-5	14-1/4" Stainless Steel Tip-Out Tray	14 1/4" (362 mm)W x See Image for Depth x 3" (77 mm)H	Stainless Steel	20	12 lb.	\$16.95 ea.
65*1-16-5	16" Stainless Steel Tip-Out Tray	16" (407 mm)W x See Image for Depth x 3" (77 mm)H	Stainless Steel	20	13 lb.	\$16.95 ea.
65*1-19-5	19" Stainless Steel Tip-Out Tray	19" (483 mm)W x See Image for Depth x 3" (77 mm)H	Stainless Steel	20	14 lb.	\$18.25 ea.
65*1-22-5	22" Stainless Steel Tip-Out Tray	22" (559 mm)W x See Image for Depth x 3" (77 mm)H	Stainless Steel	20	17 lb.	\$19.60 ea.
65*1-25-5	25" Stainless Steel Tip-Out Tray	25" (635 mm)W x See Image for Depth x 3" (77 mm)H	Stainless Steel	20	19 lb.	\$21.15 ea.
65*1-28-5	28" Stainless Steel Tip-Out Tray	28" (711 mm)W x See Image for Depth x 3" (77 mm)H	Stainless Steel	20	21 lb.	\$22.20 ea.
65*1-31-5	31" Stainless Steel Tip-Out Tray	31" (788 mm)W x See Image for Depth x 3" (77 mm)H	Stainless Steel	20	23 lb.	\$22.50 ea.

NOTES: Replace * in part numbers with an "8" for a 2 1/8" Deep Tray or a "4" for a Slim Series, (1 1/16") Tray. Ex 6541-10-4 or 6581-10-4

To order **INDIVIDUAL** packed trays with (1) pair of hinges, apply the same depth notation (4 or 8) and change the last sequence of numbers to -52. Ex. 6541-10-52 or 6581-10-52 (Call for pricing)

To order **TRAYS WITH TABS** replace * in part number for "9". Ex 6591-10-4 (Call for pricing) US PATENT NO: 7,635,171

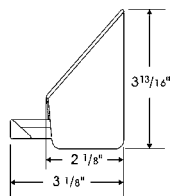

65** SERIES TIP-OUT TRAYS WITH TAB STOPS

- Affordable alternative to the conventional tray systems
- Installs easily with standard hinges
- Features high-resistant tabs to prevent easy breaking

PRODUCT #	DESCRIPTION	DIMENSIONS	FINISH	SET PER CTN	WHT PER CARTON	SUGGESTED LIST PRICE
Trays with Tab Stops (Individual Pack)						
6562-11-**-52	Two 11" Trays with Tab Stops	12½" (318 mm)W x 2½" (54 mm)D x 3⅜" (97 mm)H	Polymer Trays	1	1 lb.	\$14.50
6562-14-**-52	Two 14" Trays with Tab Stops	15½" (394 mm)W x 2½" (54 mm)D x 3⅜" (97 mm)H	Polymer Trays	1	1 lb.	\$15.35
Bulk Pack by Components						
6561-11-**-4	Forty 11" Trays with Tab Stops	12½" (318 mm)W x 2½" (54 mm)D x 3⅜" (97 mm)H	Polymer Trays	40 Trays	16 lb.	\$5.80 ea.
6561-14-**-4	Forty 14" Trays with Tab Stops	15½" (394 mm)W x 2½" (54 mm)D x 3⅜" (97 mm)H	Polymer Trays	40 Trays	18 lb.	\$5.80 ea.

NOTES:

** Product available in two colors: 11 White & 15 Almond

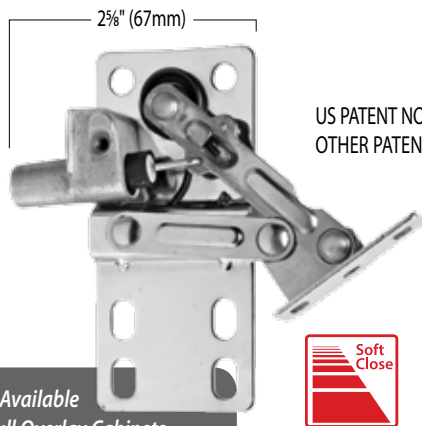

US PATENT NO: 7,635,171
OTHER PATENTS PENDING

Now Available
for Full Overlay Cabinets

LD-0220 SERIES SOFT-CLOSE TIP-OUT HINGES

- Eliminates slamming
- 50° opening
- Stiffening ribs provide extra stability and eliminate side play

See page 65 for hinge/tray combinations

PRODUCT #	DESCRIPTION	DIMENSIONS	FINISH	SET PER CTN	WHT PER CARTON	SUGGESTED LIST PRICE
Soft-Close Pivot Hinges (Bulk Pack)						
LD-0220-50SC-40	Soft-Close Tip-Out Hinge	1" (26 mm)W x 2 5/8" (67 mm)D x 3 7/8" (99 mm)H	Metal	40 pr.	22 lb.	\$15.35 pr.
LD-0220-50SCFO-40	Soft-Close Tip Out Hinge for Full Overlay	1¼" (32 mm)W x 2 5/8" (67 mm)D x 3 7/8" (99 mm)H	Metal	40 pr.	22 lb.	\$15.35 pr.



US PATENT NO: 7,635,171

LD-0220 SERIES 45° PIVOT HINGE

- Spring design closes firmly and stays closed
- Stiffening ribs provide extra stability
- Face frame or frameless compatible

PRODUCT #	DESCRIPTION	DIMENSIONS	FINISH	SET PER CTN	WHT PER CARTON	SUGGESTED LIST PRICE
Pivot Hinges (Bulk Pack)						
LD-0220-45-40	45° Pivot Hinge	1" (26 mm)W x 1¼" (45 mm)D x 3 7/8" (99 mm)H	Metal	40 pr.	17.4 lb.	\$6.65 pr.

SINK AND BASE ACCESSORIES

-

6552-95-0220-4

Technical drawing of a fire door assembly showing side and end views with dimensions:

- Side View (Left):**
 - Top edge: $\frac{1}{16}$ " MAX. RISE
 - Door thickness: $1\frac{3}{4}$ "
 - Height: $3\frac{13}{16}$ "
 - Angle: 45°
 - Label: "DOOR BELOW OPEN"
 - Label: "MIN. CLEARANCE"
 - Bottom edge: $\frac{1}{16}$ "
- End View (Right):**
 - Height: $3\frac{13}{16}$ " (97 mm)
 - Top edge: $1"$ (26 mm)
 - Bottom edge: $1"$ (26 mm)

NOTE: The hinge profile shows the function of our Self-Holdin[®] Brand Hinges. Less than 2 mm of clearance is needed for the counter top and no clearance is needed below the false front.

- Designed for long sink front false panels
- Features an adjustable opening of 45 to 90 degrees

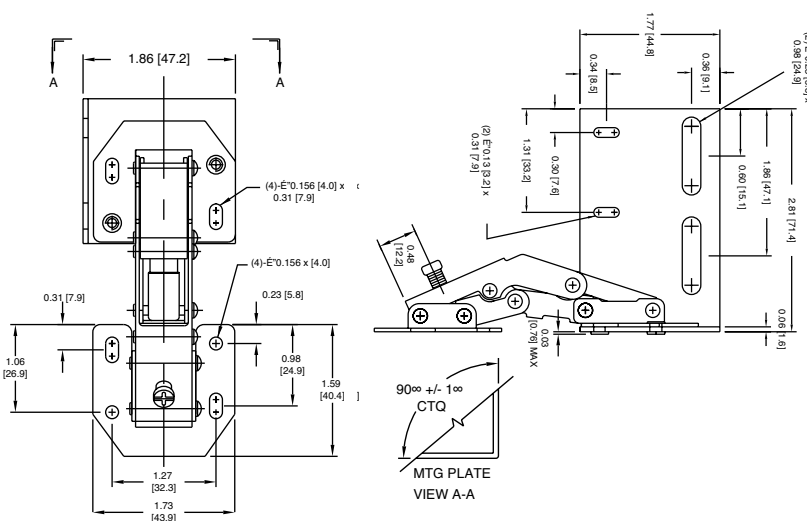

NOTE: The ETH Hinge also can be used on cook top false fronts or in the bathroom on a vanity cabinet with a false front. Chrome plating allows for installation in any application.

HURV SERIES

PULLOUT UTILITY BASKET

- Features a polymer basket
- Sturdy wire frame
- Full-extension slides
- Simple installation with just four screws
- See page 21 for door mount kit



BATHROOM

SINK AND BASE
ACCESSORIES



KITCHEN/CLEANING



EASY REMOVAL



LAUNDRY ROOM



FITS UNDER PLUMBING



GARAGE/CAR

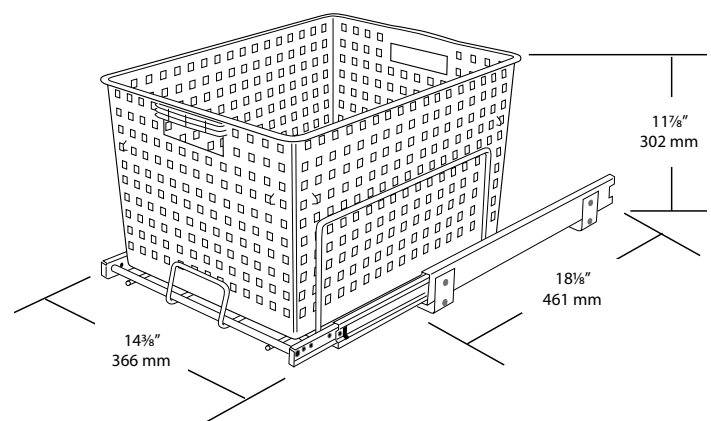

PRODUCT #	DESCRIPTION	DIMENSIONS	FINISH	SET PER CTN	WHT PER CARTON	SUGGESTED LIST PRICE
Polymer Utility Basket (Individual Pack)						
HURV-1512 S	Utility Basket	14 3/8" (364 mm)W x 18 1/8" (461 mm)D x 11 7/8" (302 mm)H	Polymer	1	10 lb.	\$153.55
HUB-470X8	Replacement Utility Basket		Polymer	1	5 lb.	\$50.75

CONTAINS:

(1) Polymer utility basket with frame, full-extension slides and 4 screws, 100 lb. Weight Rating Door Mount Brackets Sold Separately (RV DM KIT)

548 SERIES TWO-TIER BASE ORGANIZER

548-06CR-1

- Designed for Base 9" cabinets
- Features universal brackets for right or left hand mounting
- Ball-bearing slides
- Door mountable chrome frame



548-06CR-1



548-10CR-1

548-10CR-1

- Designed to fit around most plumbing applications
- Features a sturdy construction
- Features universal brackets for right or left hand mounting
- Ball-bearing slides

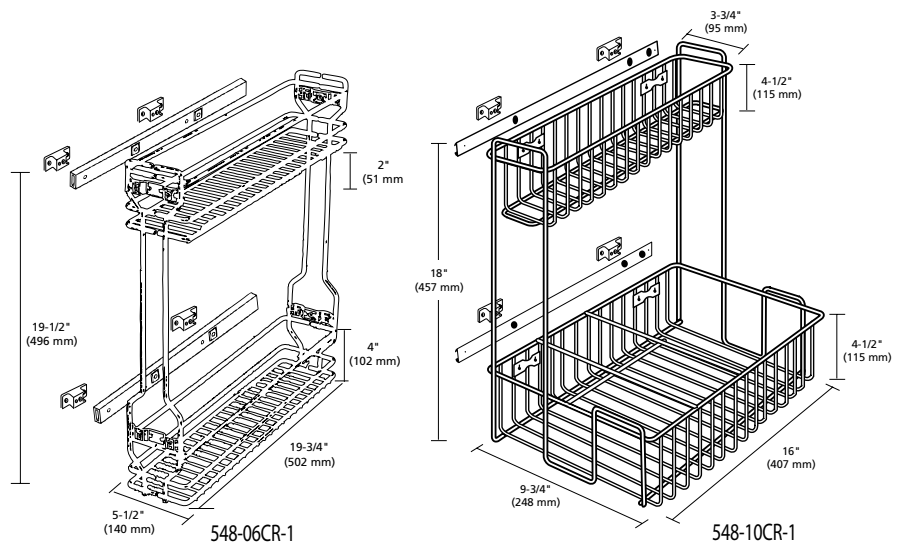

PRODUCT #	DESCRIPTION	DIMENSIONS	FINISH	SET PER CTN	WHT PER CARTON	SUGGESTED LIST PRICE
Base Organizers (Individual Pack)						
548-06CR-1	Two-Tier Base Organizer	5½" (140 mm)W x 19¾" (482 mm)D x 19½" (498 mm)H	Chrome	1	8 lb.	\$89.30
548-10CR-1	Sink Base Organizer	9¾" (248 mm)W x 16" (407 mm)D x 18" (457 mm)H	Chrome	1	6.5 lb.	\$106.60

CONTAINS:

548-06 Base 9" Organizer with reversible ball-bearing slides and 12½" (318 mm) extension with door mounting capability. Mounting screws and spacers included for slides.

548-10 Reversible Base Organizer with 16" (407 mm) slides. Mounting screws and spacers included for slides.

544 SERIES

UNDERSINK CHROME BASKET

- Store multiple cleaning items in this removable caddy
- Unique handle adjusts to accommodate plumbing fixtures
- Reversible/removable top tray

SINK AND BASE
ACCESSORIES



Removable caddy allows you to take cleaning items with you and the added bottom bumpers provide stability and protect surfaces from marring



Adjustable handle that slides horizontally and a reversible/removable top tray to accommodate plumbing fixtures



PRODUCT #	DESCRIPTION	DIMENSIONS	FINISH	SET PER CTN	WHT PER CARTON	SUGGESTED LIST PRICE
Undersink Chrome Basket (Individual Pack)						
544-10C-1	Undersink Chrome Basket	11¼" (286 mm)W x 16¼" (413 mm)D x 19½" (498 mm)H	Chrome	1	4.5 lb.	\$85.40

5WB SERIES

SINGLE CHROME BASKETS

- Ideal for organizing pots, pans and other bulky items
- Features full-extension ball-bearing slides
- Heavy-Duty Chrome plated frames
- Available in 18", 20" and 22" slides

SINK AND BASE ACCESSORIES



Slide units install easily with four screws!



PRODUCT #	DESCRIPTION	DIMENSIONS	MINIMUM OPENING	FINISH	SET PER CTN	WHT PER CARTON	SUGGESTED LIST PRICE
Single Chrome Pullout Basket (Individual Pack)							
5WB1-0918-CR	9" Single Pullout Wire Basket	8 $\frac{3}{8}$ " (213 mm)W x 18" (457 mm)D x 7" (178 mm)H	8 $\frac{1}{2}$ " (216 mm)	Chrome	1	7.7 lb.	\$53.65
5WB1-1218-CR	12" Single Pullout Wire Basket	11 $\frac{3}{8}$ " (289 mm)W x 18" (457 mm)D x 7" (178 mm)H	11 $\frac{1}{2}$ " (292 mm)	Chrome	1	8.8 lb.	\$57.70
5WB1-1220-CR	12" Single Pullout Wire Basket	11 $\frac{3}{8}$ " (289 mm)W x 20" (508 mm)D x 7" (178 mm)H	11 $\frac{1}{2}$ " (292 mm)	Chrome	1	9.5 lb.	\$65.85
5WB1-1520-CR	15" Single Pullout Wire Basket	14 $\frac{3}{8}$ " (365 mm)W x 20" (508 mm)D x 7" (178 mm)H	14 $\frac{1}{2}$ " (368 mm)	Chrome	1	10.7 lb.	\$73.65
5WB1-1222-CR	12" Single Pullout Wire Basket	11 $\frac{3}{8}$ " (289 mm)W x 22" (559 mm)D x 7" (178 mm)H	11 $\frac{1}{2}$ " (292 mm)	Chrome	1	9.9 lb.	\$71.50
5WB1-1522-CR	15" Single Pullout Wire Basket	14 $\frac{3}{8}$ " (365 mm)W x 22" (559 mm)D x 7" (178 mm)H	14 $\frac{1}{2}$ " (368 mm)	Chrome	1	11.2 lb.	\$79.60
5WB1-1822-CR	18" Single Pullout Wire Basket	17 $\frac{3}{8}$ " (441 mm)W x 22" (559 mm)D x 7" (178 mm)H	17 $\frac{1}{2}$ " (445 mm)	Chrome	1	12.4 lb.	\$86.15
5WB1-2122-CR	21" Single Pullout Wire Basket	20 $\frac{3}{8}$ " (518 mm)W x 22" (559 mm)D x 7" (178 mm)H	20 $\frac{1}{2}$ " (521 mm)	Chrome	1	13.9 lb.	\$95.25
5WB-DMKIT	Door Mount Kit			Silver	1	3 lb.	\$32.75

CONTAINS: (1) Wire Basket, full-extension slides - 100 lb. Weight Rating

NOTES: Comes fully assembled and installs with four screws.



5WB SERIES

TWO-TIER CHROME BASKETS

- Features full-extension ball-bearing slides
- Heavy-Duty Chrome plated baskets
- Simple installation
- Telescoping rear mounting bracket
- Features U-Shaped support bracket

SINK AND BASE
ACCESSORIES

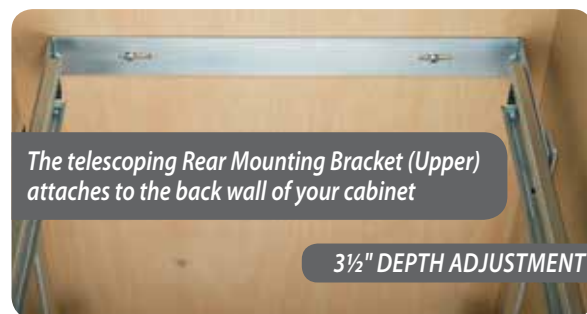

PRODUCT #	DESCRIPTION	DIMENSIONS	MINIMUM OPENING	FINISH	SET PER CTN	WHT PER CARTON	SUGGESTED LIST PRICE
Double Chrome Pullout Basket (Individual Pack)							
5WB2-0918-CR	9" Double Pullout Wire Basket	8¾" (222 mm) W x 18" (457 mm)D x 19" (483 mm)H	8½" (216 mm)	Chrome	1	15.2 lb.	\$120.65
5WB2-1218-CR	12" Double Pullout Wire Basket	11¾" (299 mm) W x 18" (457 mm)D x 19" (483 mm)H	11½" (292 mm)	Chrome	1	17.2 lb.	\$133.25
5WB2-1222-CR	12" Double Pullout Wire Basket	11¾" (299 mm) W x 22" (559 mm)D x 19" (483 mm)H	11½" (292 mm)	Chrome	1	18.9 lb.	\$149.20
5WB2-1522-CR	15" Double Pullout Wire Basket	14¾" (375 mm) W x 22" (559 mm)D x 19" (483 mm)H	14½" (368 mm)	Chrome	1	20.9 lb.	\$152.55
5WB2-1822-CR	18" Double Pullout Wire Basket	17¾" (451 mm) W x 22" (559 mm)D x 19" (483 mm)H	17½" (445 mm)	Chrome	1	22.9 lb.	\$165.75
5WB2-2122-CR	21" Double Pullout Wire Basket	20¾" (527 mm) W x 22" (559 mm)D x 19" (483 mm)H	20½" (521 mm)	Chrome	1	25.1 lb.	\$179.35
5WB-DMKIT	Door Mount Kit			Silver	1	3 lb.	\$32.75

CONTAINS: (2) Wire Baskets, (2 pair) full-extension slides - 100 lb. Weight Rating, (2) U-Brackets, (1) Adjustable Rear Mounting Bracket

NOTES: Easy assembly, installs with seven screws.

5CW2 SERIES TWO-TIER COOKWARE ORGANIZER

- Features independently operating shelves that accommodate a variety of cookware sizes and brands
- Top tier organizes lids
- Bottom tier features adjustable dividers to store a variety of larger pots and pans
- Designed for Base 15" or 24" cabinets
- Made with a heavy-duty chrome plated wire frame
- Glides effortlessly on 100 lb. rated full-extension ball-bearing slides
- Bottom, side, and rear mounts
- See page 21 for door mount kit

US PATENT NO: D588,415



5CW2-2122-CR

US PATENT NO: D588,415 S



5CW2-1222-CR



5CW2-1222-CR

PRODUCT #	DESCRIPTION	DIMENSIONS	MINIMUM OPENING	FINISH	SET PER CTN	WHT PER CARTON	SUGGESTED LIST PRICE
Two-Tier Cookware Organizer (Individual Pack)							
5CW2-1222-CR	12" Two-Tier Cookware Organizer	11¾" (299 mm) W x 22" (559 mm) D x 18" (457 mm) H	11½" (292 mm)	Chrome	1	21 lb.	\$158.20
5CW2-2122-CR	21" Two-Tier Cookware Organizer	20¾" (527 mm) W x 22" (559 mm) D x 18½" (460 mm) H	20½" (521 mm)	Chrome	1	26 lb.	\$288.40
RV DM17 KIT	Heavy Duty Door Mount Kit (Includes Euro Adapter Kit)			Silver	1	3 lb.	\$33.50

CONTAINS: (2 pair) full-extension slides - 100 lb. Weight Rating, (2) U-Brackets, (2) Back Mounting Brackets (attached to slides)

NOTES: Easy assembly, installs with seven screws.

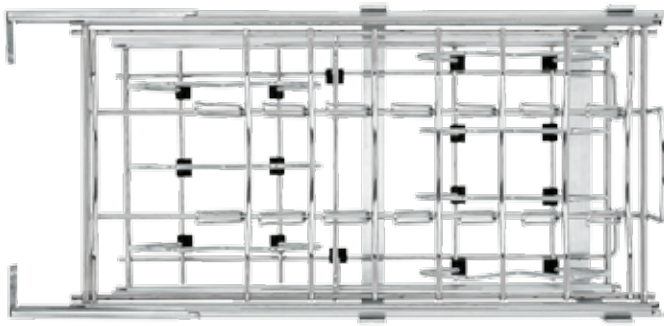

5CW2-1222-CR: STORAGE FOR 7 LIDS

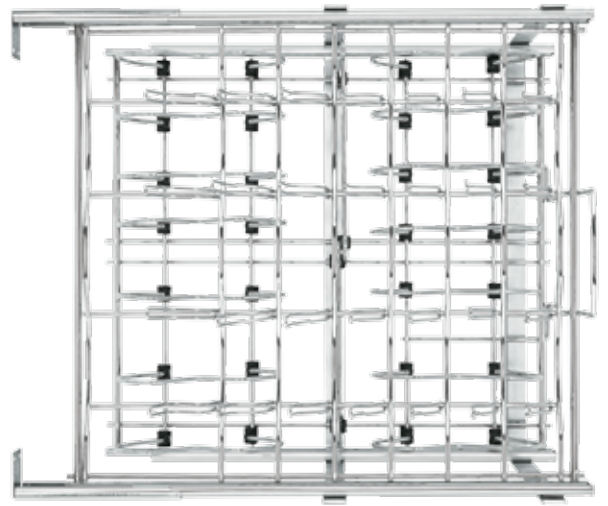

5CW2-2122-CR: STORAGE FOR 14 LIDS

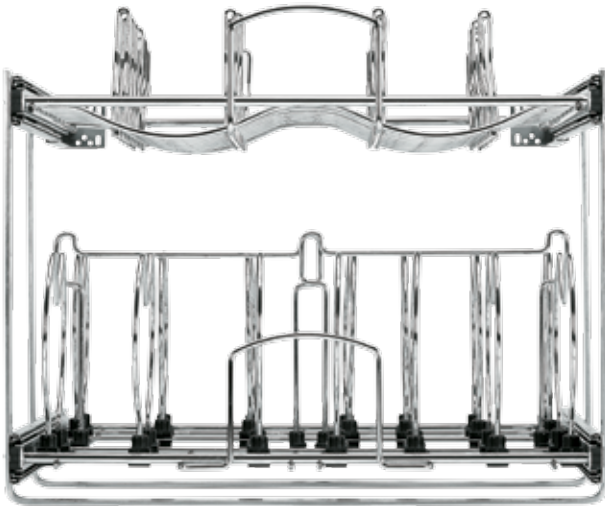

ADJUSTABLE DIVIDERS



Unique installation allows use of larger cabinets

SINK AND BASE
ACCESSORIES



DOOR MOUNT BRACKETS AVAILABLE

5CW2-2122-CR

4SBSU SERIES

SINK BASE DOOR STORAGE

- UV-cured maple with clear finish
- Available in three sizes for sink base 30", 36" and 42"
- Features the patented adjustable door mount brackets
- Brackets provide installation flexibility up to 5"

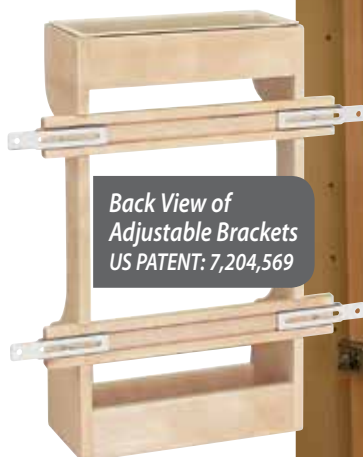

Back View of
Adjustable Brackets
US PATENT: 7,204,569



Features a polymer tray on the top shelf that can be removed for easy cleaning.

PRODUCT #	DESCRIPTION	DIMENSIONS	MINIMUM OPENING	FINISH	SET PER CTN	WHT PER CARTON	SUGGESTED LIST PRICE
Sink Base Door Storage (Individual Pack)							
4SBSU-15	Sink Storage Shelving System	10½" (267 mm)W x 5" (127 mm)D x 18½" (470 mm)H	11½" (295 mm)	Wood	1	7 lb.	\$57.70
4SBSU-18	Sink Storage Shelving System	13½" (343 mm)W x 5" (127 mm)D x 18½" (470 mm)H	14¾" (366 mm)	Wood	1	7 lb.	\$62.80
4SBSU-21	Sink Storage Shelving System	16½" (419 mm)W x 5" (127 mm)D x 18½" (470 mm)H	17¼" (439 mm)	Wood	1	8 lb.	\$72.20

CONTAINS: (1) shelf system, (4) AMB (Adjustable Mounting Brackets) and (4) screws

4SPBD SERIES

GROCERY BAG HOLDER

- UV-cured maple with clear finish
- Features the patented adjustable door mount brackets
- Brackets provide installation flexibility up to 5"



Adjustable Mounting Brackets
US PATENT: 7,204,569



Features a polymer tray on the top shelf that can be removed for easy cleaning.

PRODUCT #	DESCRIPTION	DIMENSIONS	MINIMUM OPENING	FINISH	SET PER CTN	WHT PER CARTON	SUGGESTED LIST PRICE
Sink Base Door Storage (Individual Pack)							
4SPBD-15	Grocery Bag Holder for Base 15	10½" (267 mm)W x 5" (127 mm)D x 18½" (473 mm)H	11½" (295 mm)	Wood	1	7 lb.	\$76.25
4SPBD-18	Grocery Bag Holder for Base 18	13½" (343 mm)W x 5" (127 mm)D x 18½" (473 mm)H	14¾" (366 mm)	Wood	1	7.8 lb.	\$83.65

CONTAINS: (1) shelf system, (4) AMB (Adjustable Mounting Brackets) and (4) screws



Adjustable Mounting Brackets
US PATENT: 7,204,569

4DMCB SERIES

DOOR MOUNT CUTTING BOARD

- Maple hardwood cutting board
- Mineral oil treated
- Support racks are coated with a UV-cured clear finish
- Brackets provide installation flexibility up to 5"

4DMCB-15	WIDTH	DEPTH	HEIGHT
Mount Rack	10½" (267 mm)	2⅞" (73 mm)	8" (203 mm)
Cutting Board	7¾" (197 mm)	1¼" (32 mm)	16" (407 mm)

4DMCB-18	WIDTH	DEPTH	HEIGHT
Mount Rack	13½" (343 mm)	2⅞" (73 mm)	8" (203 mm)
Cutting Board	10¾" (273 mm)	1¼" (32 mm)	16" (407 mm)

PRODUCT #	DESCRIPTION	DIMENSIONS	MINIMUM OPENING	FINISH	SET PER CTN	WHT PER CARTON	SUGGESTED LIST PRICE
Door Mount Cutting Board (Individual Pack)							
4DMCB-15	Base 15" Door Mount Cutting Board	10½" (267 mm)W x 2⅞" (73 mm)D x 16⅞" (429 mm)H	10⅞" (276 mm)	Wood	1	7 lb.	\$79.15
4DMCB-18	Base 18" Door Mount Cutting Board	13½" (343 mm)W x 2⅞" (73 mm)D x 16⅞" (429 mm)H	13⅞" (353 mm)	Wood	1	10 lb.	\$89.45

CONTAINS: Door Rack, Cutting Board and Screws. **NOTE:** Mounting brackets add up to 5" (128 mm) of adjustability, 2½" (64 mm) to each side.

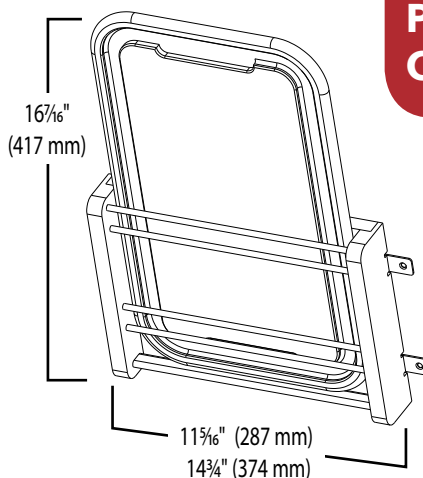

4DMCB SERIES

DOOR MOUNT POLYETHYLENE CUTTING BOARD

- Includes polyethylene cutting board
- Features the patented adjustable door mount brackets (US Patent No. 7,204,569)
- Brackets provide installation flexibility up to 5"

PRODUCT #	DESCRIPTION	DIMENSIONS	MINIMUM OPENING	FINISH	SET PER CTN	WHT PER CARTON	SUGGESTED LIST PRICE
Door Mount Polyethylene Cutting Board (Individual Pack)							
4DMCB-15P	Door Mount Polyethylene Cutting Board	11⅞" (287 mm)W x 2" (51 mm)D x 16⅞" (417 mm)H	12" (304 mm)	Wood	1	6 lb.	\$71.75
4DMCB-18P	Door Mount Polyethylene Cutting Board	14¾" (374 mm)W x 2" (51 mm)D x 16⅞" (417 mm)H	15¼" (387 mm)	Wood	1	9 lb.	\$90.65

CONTAINS:

(1) door mount cutting board, (4) AMB (Adjustable Mounting Brackets) and (4) screws US PATENT NO: 7,204,569.

4200 SERIES

WOOD DOOR STORAGE TRAYS

- Available in 11", 14" and 20" widths
- Single or five tray sets
- Feature a sleek design constructed of beautiful maple with chrome accents
- Easy to install with screw-in clips or pegboard clips
- Trays can also be mounted to 26" or 58" standards with standard clips (sold separately)

SINK AND BASE
ACCESSORIES



Two 14" Wood Storage Trays with optional
Aluminum Standard and Clips (Sold Separately)



11" Wood Storage Tray (4231-11-52) shown with included Screw-In Clips.



Aluminum Standard
with Adjustable Clip

PRODUCT #	DESCRIPTION	DIMENSIONS	FINISH	SET PER CTN	WHT PER CARTON	SUGGESTED LIST PRICE
Door Storage Trays (Individual Pack)						
4231-11-52	11" Wood Door Storage Tray W/ Screw In Clips	10 $\frac{3}{4}$ " (273 mm) W x 4 $\frac{1}{4}$ " (108 mm) D x 3 $\frac{5}{8}$ " (91 mm) H	Wood	1 tray	1.6 lb.	\$37.70
4231-14-52	14" Wood Door Storage Tray W/ Screw In Clips	13 $\frac{3}{4}$ " (349 mm) W x 4 $\frac{1}{4}$ " (108 mm) D x 3 $\frac{5}{8}$ " (91 mm) H	Wood	1 tray	3 lb.	\$42.05
4231-20-52	20" Wood Door Storage Tray W/ Screw In Clips	19 $\frac{3}{4}$ " (502 mm) W x 4 $\frac{1}{4}$ " (108 mm) D x 3 $\frac{5}{8}$ " (91 mm) H	Wood	1 tray	5 lb.	\$47.25
Door Storage Trays (Bulk Pack)						
4235-11-5	11" Wood Door Storage Tray w/Screw In Clips	10 $\frac{3}{4}$ " (273 mm) W x 4 $\frac{1}{4}$ " (108 mm) D x 3 $\frac{5}{8}$ " (91 mm) H	Wood	5 tray	8 lb.	\$28.55 ea.
4235-14-5	14" Wood Door Storage Tray w/Screw In Clips	13 $\frac{3}{4}$ " (349 mm) W x 4 $\frac{1}{4}$ " (108 mm) D x 3 $\frac{5}{8}$ " (91 mm) H	Wood	5 tray	12 lb.	\$30.60 ea.
4235-20-5	20" Wood Door Storage Tray w/Screw In Clips	19 $\frac{3}{4}$ " (502 mm) W x 4 $\frac{1}{4}$ " (108 mm) D x 3 $\frac{5}{8}$ " (91 mm) H	Wood	5 tray	18 lb.	\$35.55 ea.
Hardware						
6232-26-4528-52	Pair Aluminum Standards & 4 Clips	26" (660 mm) L	Bright Aluminum	1 pr.	1 lb.	\$44.25
6232-58-4528-52	Pair Aluminum Standards & 10 Clips	58" (1473 mm) L	Bright Aluminum	1 pr.	2 lb.	\$61.75

CONTAINS: Door Storage Trays with Screw-In Clips.

NOTE: Aluminum Standards with adjustable clips are sold separately. Additional tray clips may be ordered - Part No: 6231-41-4101-10

4WB SERIES

BASE WOOD SWING-OUT PANTRY

SINK AND BASE
ACCESSORIES



Adjustable Mounting Brackets
US PATENT: 7,204,569



Chrome Top Rails can be
installed to store items!

- Designed for 36" full height base cabinets
- Adjustable interior door and pantry shelves
- Removable chrome bars
- Maple shelving with a UV-cured, clear finish
- Swings out on an industrial piano hinge
- Kit includes two swing-out units and two door storage units

See page 120 for Pantry Cabinet version
See page 121 for a detailed line drawing of
swing radius and dimensions.

MINIMUM
CABINET HEIGHT
4WBP18-25-KIT
25³/₄" (654 mm)
without top rails
28³/₄" (730 mm)
with top rails



NOTE: CENTER WOOD PIECE NOT INCLUDED

PRODUCT #	DESCRIPTION	DIMENSIONS	FINISH	SET PER CTN	WHT PER CARTON	SUGGESTED LIST PRICE
Swing Out Pantry (Individual Pack)						
4WBSP18-25	25" Swing Out Pantry (w/Hardware) Single	12" (305 mm)W x 7 ¹ / ₂ " (191 mm)D x 25" (635 mm)H	Wood	1	17 lb.	\$117.60
4WBDP18-25	25" Pantry Door Unit (w/Hardware) Single	12" (305 mm)W x 4" (102 mm)D x 25" (1296 mm)H	Wood	1	11 lb.	\$105.40
4WBP18-25-KIT	25" Swing Out Pantry Kit - Includes (2) 4WBSP18-25 and (2) 4WBDP18-25		Wood	1	60 lb.	\$425.70

4WV SERIES

WOVEN BASKETS WITH RAILS

- Feature machine washable canvas liners
- Baskets secured within a natural maple frame, complete with built-in handles
- Easy four screw installation for side mount rails
- Offered in Standard and Euro sizes

SINK AND BASE
ACCESSORIES



Product Part	Width Before Rails are Cut	Min. after Rails are Cut	Depth	Height
4WV-15I	14½" (362 mm)	12¼" (312 mm)	21¼" (540 mm)	7¾" (188 mm)
4WV-18I	17½" (445 mm)	15¼" (388 mm)	21¼" (540 mm)	7¾" (188 mm)
4WV-320I	361 mm (14½")	346 mm (13½")	451 mm (17¾")	195 mm (7⅞")
4WV-420I	461 mm (18½")	446 mm (17½")	451 mm (17¾")	195 mm (7⅞")
4WV-520I	561 mm (22½")	546 mm (21½")	451 mm (17¾")	195 mm (7⅞")

PRODUCT #	DESCRIPTION	DIMENSIONS	FINISH	SET PER CTN	WHT PER CARTON	SUGGESTED LIST PRICE
Woven Basket with Rails (Individual Pack)						
4WV-15I	Base 15 Woven Basket with Rails	See dimensions in the chart above.	Eucalyptus	1	6 lb.	\$97.45
4WV-18I	Base 18 Woven Basket with Rails	See dimensions in the chart above.	Eucalyptus	1	7 lb.	\$103.40
Euro Rail Woven Baskets (Individual Pack)						
4WV-320I	320 mm Woven Basket with Rails	See dimensions in the chart above.	Eucalyptus	1	6 lb.	\$95.25
4WV-420I	420 mm Woven Basket with Rails	See dimensions in the chart above.	Eucalyptus	1	6 lb.	\$104.70
4WV-520I	520 mm Woven Basket with Rails	See dimensions in the chart above.	Eucalyptus	1	8 lb.	\$114.85

NOTE:

Euro Basket Rails sizes are 29 mm (1⅛")W x 451 mm (17¾")D x 32 mm (1¼")H.

Standard Basket Rails sizes are 2" (51 mm)W x 21¼" (540 mm) x 1⅝" (33 mm)H.

CONTAINS:

(1) Woven Basket, (1) Canvas Liner and (2) side mount rails.

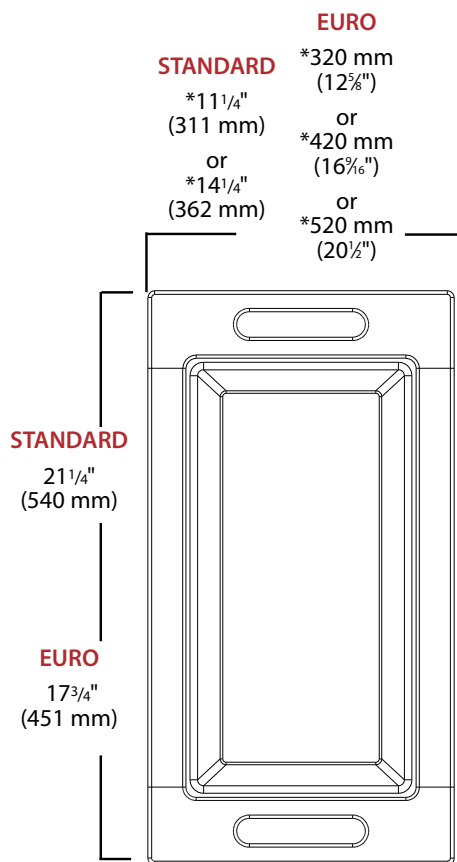

Basket Width Only (no rails)

EURO SIZES

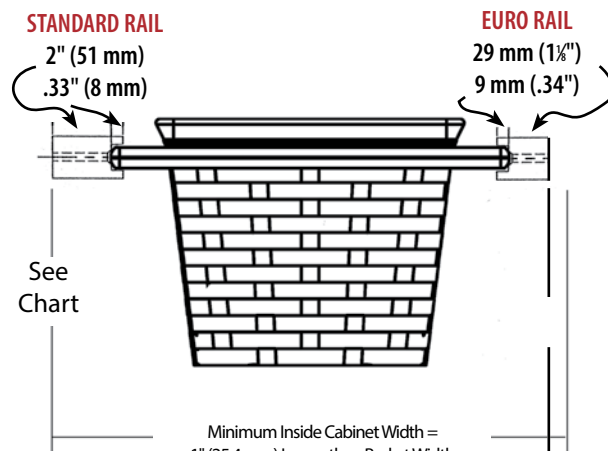

Minimum Inside Cabinet Width =
1" (25.4 mm) Larger than Basket Width

Maximum Inside Cabinet Width =
3.34" (85 mm) Larger than Basket Width

Euro Maximum Inside Cabinet Width =
1.57" (39.9 mm) Larger than Basket Width

***Width + 3/8" (9.5 mm) =
Minimum
Cabinet Opening**

SINK AND BASE
ACCESSORIES



4WV SERIES

STATIC WOVEN BASKETS

In need of functional decorative bins? Look no further than Rev-A-Shelf's Static Woven Baskets, featuring stylish machine washable canvas liners.

See page 163 for wall cabinet version

PRODUCT #	DESCRIPTION	DIMENSIONS	FINISH	SET PER CTN	WHT PER CARTON	SUGGESTED LIST PRICE
Static Woven Baskets						
4WV-421-4	Static Woven Basket	4" (102 mm)W x 21" (531 mm)D x 4 1/4" (108 mm)H	Eucalyptus	4	7 lb.	\$42.05
4WV-1419-52	Static Woven Basket	14 1/4" (362 mm)W x 19" (483 mm)D x 11" (280 mm)H	Eucalyptus	1	6 lb.	\$89.30
4WV-1723-52	Static Woven Basket	17 1/4" (439 mm)W x 22 1/2" (572 mm)D x 11" (280 mm)H	Eucalyptus	1	8 lb.	\$126.60

NOTE: 4WV-421 Series Sold as a set of (4), Suggested List Price is per basket. These items are hand-woven baskets, allow 1/8" total variance.

CONTAINS: 4WV-421 Series (4) Woven Baskets and (4) Canvas Liners 4WV1419/4WV1729 Series (1) Woven Basket and (1) Canvas Liner

4WDB SERIES

WOOD PULLOUT DRAWER

- Designed to add functionality to your base cabinets
- Features dovetail constructed veneer plywood
- Glides on concealed bottom mount 3/4 extension slides
- Simple installation

SINK AND BASE
ACCESSORIES



4WDB-15



SOLID DOVETAIL CONSTRUCTION



CONCEALED BOTTOM MOUNT 3/4 EXTENSION SLIDES

PRODUCT #	DESCRIPTION	DIMENSIONS	FINISH	SET PER CTN	WHT PER CARTON	SUGGESTED LIST PRICE
Wood Pullout Drawer (Individual Pack)						
4WDB-12	Base 15 Wood Pullout Drawer	11" (280 mm)W x 18½" (470 mm)D x 5⅝" (143 mm)H	Wood	1	32 lb.	\$77.60
4WDB-15	Base 18 Wood Pullout Drawer	14" (356 mm)W x 22½" (572 mm)D x 5⅝" (143 mm)H	Wood	1	53 lb.	\$90.05

CONTAINS: (1) Completely assembled wood pullout drawers, mounting hardware, 50 lb. Weight Rated, ¾ extension Euro Slides.

432 SERIES

BASE CABINET FILLERS

- Create a functional storage space behind those decorative panels
- Available for 3", 6" and 9" base cabinet applications
- Features adjustable shelves with chrome rails
- Full-extension ball-bearing slides
- Three slide design provides stability

See page 164 for wall cabinet version
See page 85 for soft-close version

SINK AND BASE
ACCESSORIES



432-BF-3C



432-BF-9C

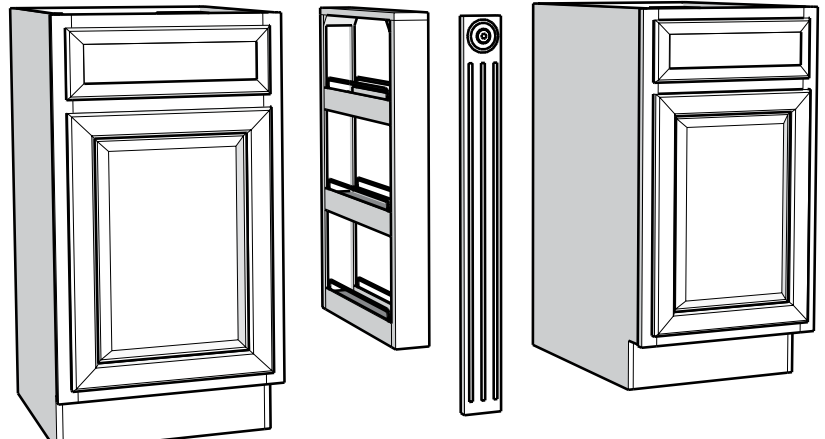

Installation is easy! Simply attach the organizer to adjacent cabinets and add a filler front and decorative onlay for a completely functional storage pullout.

PRODUCT #	DESCRIPTION	DIMENSIONS	FINISH	SET PER CTN	WHT PER CARTON	SUGGESTED LIST PRICE
Base Filler Organizer (Individual Pack)						
432-BF-3C	3" Filler Organizer	3" (76 mm)W x 23" (584 mm)D x 30" (762 mm)H	Wood	1	21 lb.	\$160.65
432-BF-6C	6" Filler Organizer	6" (152 mm)W x 23" (584 mm)D x 30" (762 mm)H	Wood	1	33 lb.	\$193.45
432-BF-9C	9" Filler Organizer	9" (229 mm)W x 23" (584 mm)D x 30" (762 mm)H	Wood	1	47 lb.	\$230.85

CONTAINS:

(1) Completely assembled organizer with full-extension slides and adjustable shelves. 9" - 150 lb. Weight Rated Slides 3", 6" - 100 lb. Weight Rated Slides

432-BFBBSC SERIES
SOFT-CLOSE
BASE CABINET
FILLERS

- Create a functional storage space behind decorative panels
- Available for 3", 6" and 9" base cabinet applications
- Features adjustable shelves with chrome rails
- Full-extension soft-close ball-bearing slides
- Three slide design provides stability

See page 83 for non soft-close version

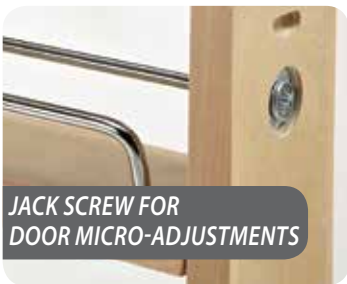

PRODUCT #	DESCRIPTION	DIMENSIONS	FINISH	SET PER CTN	WHT PER CARTON	SUGGESTED LIST PRICE
Soft-close Base Filler Organizer (Individual Pack)						
432-BFBBSC-3C	3" Filler Organizer with Soft-Close	3" (76 mm)W x 23" (584 mm)D x 30" (762 mm)H	Wood	1	21 lb.	\$205.60
432-BFBBSC-6C	6" Filler Organizer with Soft-Close	6" (152 mm)W x 23" (584 mm)D x 30" (762 mm)H	Wood	1	33 lb.	\$245.80

CONTAINS:

(1) Completely assembled organizer with full-extension slides and adjustable shelves. 100 lb. Weight Rated Slides

432-BFSC SERIES BLUM® SOFT-CLOSE BASE CABINET FILLERS

- Create a functional storage space behind those decorative panels
- Available for 3", 6" and 9" base cabinet applications
- Features adjustable shelves with chrome rails
- Middle shelf is solid for extra support
- BLUMOTION soft-close slides

See page 83 for non soft-close version

SINK AND BASE
ACCESSORIES



MIDDLE SHELF IS SOLID
FOR EXTRA SUPPORT

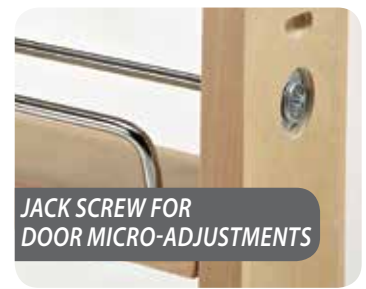

JACK SCREW FOR
DOOR MICRO-ADJUSTMENTS

PRODUCT #	DESCRIPTION	DIMENSIONS	FINISH	SET PER CTN	WHT PER CARTON	SUGGESTED LIST PRICE
Soft-close Base Filler Organizer (Individual Pack)						
432-BFSC-3C	3" Filler Organizer with Blum Soft-Close	3" (76 mm)W x 23" (584 mm)D x 30" (762 mm)H	Wood	1	21 lb.	\$248.40
432-BFSC-6C	6" Filler Organizer with Blum Soft-Close	6" (152 mm)W x 23" (584 mm)D x 30" (762 mm)H	Wood	1	33 lb.	\$290.60
432-BFSC-9C	9" Filler Organizer with Blum Soft-Close	9" (229 mm)W x 23" (584 mm)D x 30" (762 mm)H	Wood	1	42 lb.	\$362.95

CONTAINS:

(1) Completely assembled organizer with full-extension slides and shelves. 3" - 25 lb. Weight Rated Slides, 6" - 50 lb. Weight Rated Slides, 9" - 75 lb. Weight Rated Slides (BHMA 1).

434 SERIES SOFT-CLOSE BASE CABINET FILLERS

- Features full-extension ball-bearing soft-close slides
- Available in 3" and 6"
- Magnetic grade stainless steel panel and a variety accessory hooks and pegs included
- Additional accessory hooks can be purchased separately
- Non soft-close version also available
- See page 165 for wall version (non soft-close)

SINK AND BASE
ACCESSORIES



434-BFBBSC-3SS

PRODUCT #	DESCRIPTION	DIMENSIONS	FINISH	SET PER CTN	WHT PER CARTON	SUGGESTED LIST PRICE
Base Filler Organizer with Stainless Panel (Individual Pack)						
434-BF-3SS	3" Filler Organizer	3" (76 mm)W x 23" (584 mm)D x 30" (762 mm)H	Wood	1	25 lb.	\$320.30
434-BF-6SS	6" Filler Organizer	6" (152 mm)W x 23" (584 mm)D x 30" (762 mm)H	Wood	1	39 lb.	\$359.45
434-BFBBSC-3SS	3" Filler Organizer w/ Soft-close	3" (76 mm)W x 23" (584 mm)D x 30" (762 mm)H	Wood	1	25 lb.	\$335.95
434-BFBBSC-6SS	6" Filler Organizer w/ Soft-close	6" (152 mm)W x 23" (584 mm)D x 30" (762 mm)H	Wood	1	39 lb.	\$407.45

PRODUCT #	DESCRIPTION	FINISH	SET PER CTN	WHT PER CARTON	SUGGESTED LIST PRICE
Accessories (Bulk Pack)					
434-Multi-5	5-Hole Rack	Rubberized Black	5	.12 lb.	\$7.40 ea.
434-S3-5	3" Single Hook	Rubberized Black	5	.8 lb.	\$2.75 ea.
434-D3-5	3" Double Hook	Rubberized Black	5	.8 lb.	\$4.05 ea.
434-Peg3-6	3" Peg	Rubberized Black	6	.28 lb.	\$3.50 ea.
434-S6-5	6" Single Hook	Rubberized Black	5	.8 lb.	\$3.05 ea.
434-D6-5	6" Double Hook	Rubberized Black	5	.13 lb.	\$4.50 ea.
434-Peg6-6	6" Peg	Rubberized Black	6	.5 lb.	\$4.80 ea.



MAGNETIC GRADE
STAINLESS STEEL PANEL

CONTAINS:

(1) Completely assembled organizer with 100 lb. Weight Rated full-extension slides, adjustable shelves, and a variety of hooks and pegs detailed below.

434-BF-3SS – (12) 434-S3, (6) 434-D3, (12) 434-Peg3 – 1 434-Multi-5

434-BF-6SS – (6) 434-S3, (12) 434-S6, (6) 434-D6, (12) 434-Peg6

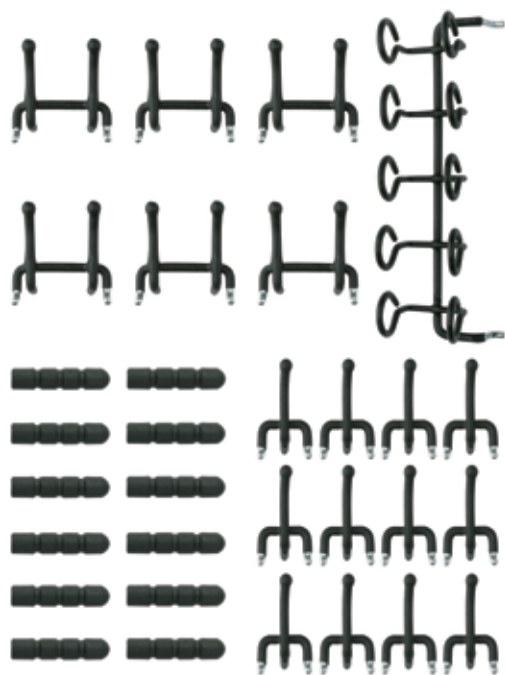
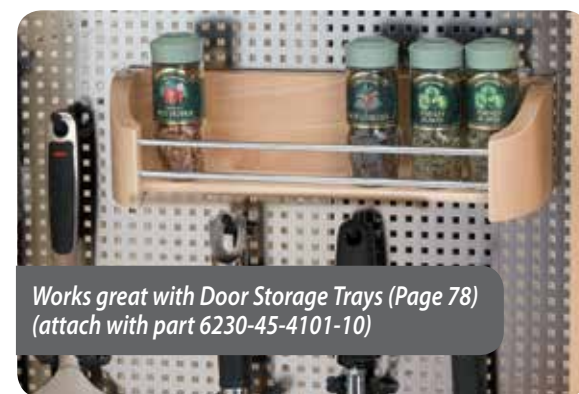

Assorted Hooks and Pegs are included with every filler!
Additional accessories may be ordered
using the part numbers provided.



433 SERIES HYBRID SOFT-CLOSE BASE CABINET FILLERS

- One side features adjustable 2-3/4" wide shelves
- Opposite side features magnetic grade stainless steel panel
- Adjustable accessory hooks included
- Features soft-close ball-bearing slides
- Additional accessory hooks can be purchased separately (pg. 87)
- Non soft-close also available



*One side features
adjustable shelves*



*One side features
stainless steel panel*



**MAGNETIC GRADE
STAINLESS STEEL PANEL**

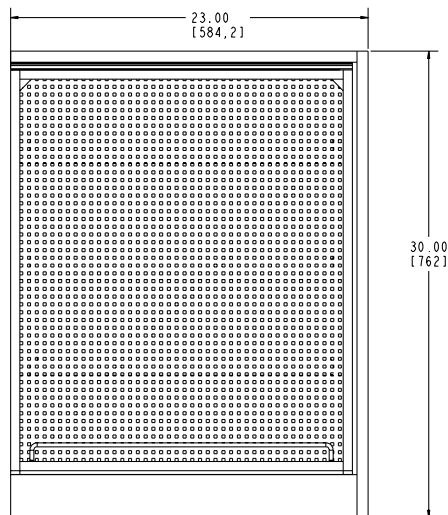
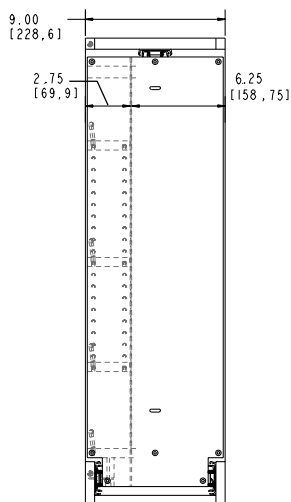

PRODUCT #	DESCRIPTION	DIMENSIONS	FINISH	SET PER CTN	WHT PER CARTON	SUGGESTED LIST PRICE
Base Filler Organizer (Individual Pack)						
433-BF-9C	9" Filler Organizer	9" (229 mm)W x 23" (584 mm)D x 30" (762 mm)H	Wood	1	32 lb.	\$434.15
433-BFBBSC-9C	9" Filler Organizer w/Soft-Close	9" (229 mm)W x 23" (584 mm)D x 30" (762 mm)H	Wood	1	48 lb.	\$465.15

CONTAINS: (1) Completely assembled organizer with 150 lb. Weight Rated full-extension slides and adjustable shelves with chrome rails, a stainless steel panel with a variety of accessory hooks and pegs.

432, 433 AND 434 SERIES FILLER PULLOUTS
GO BETWEEN TWO CABINETS, THE SAME WAY FILLER PANELS ARE USED.

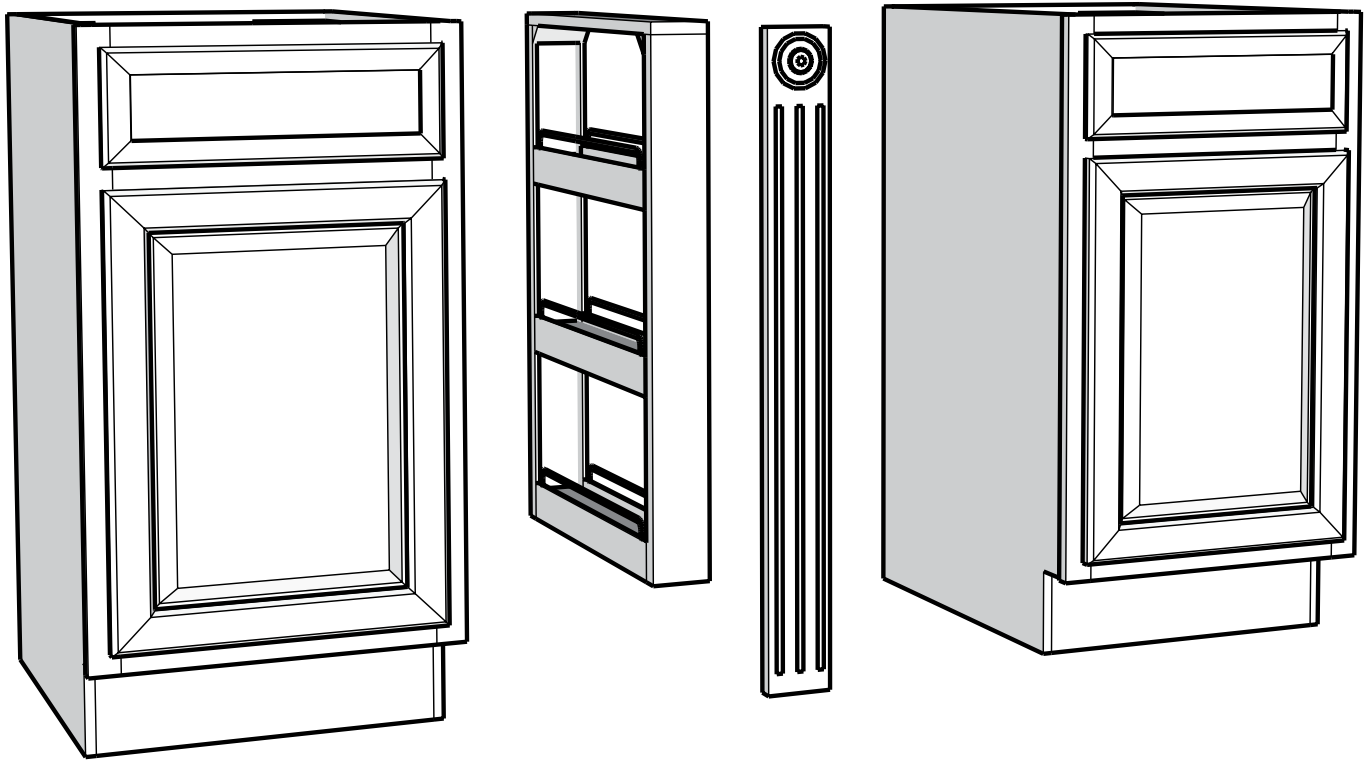

SINK AND BASE
ACCESSORIES

444, 445, 447, 438 AND 448 SERIES ORGANIZERS
GO INSIDE AN EXISTING CABINET.

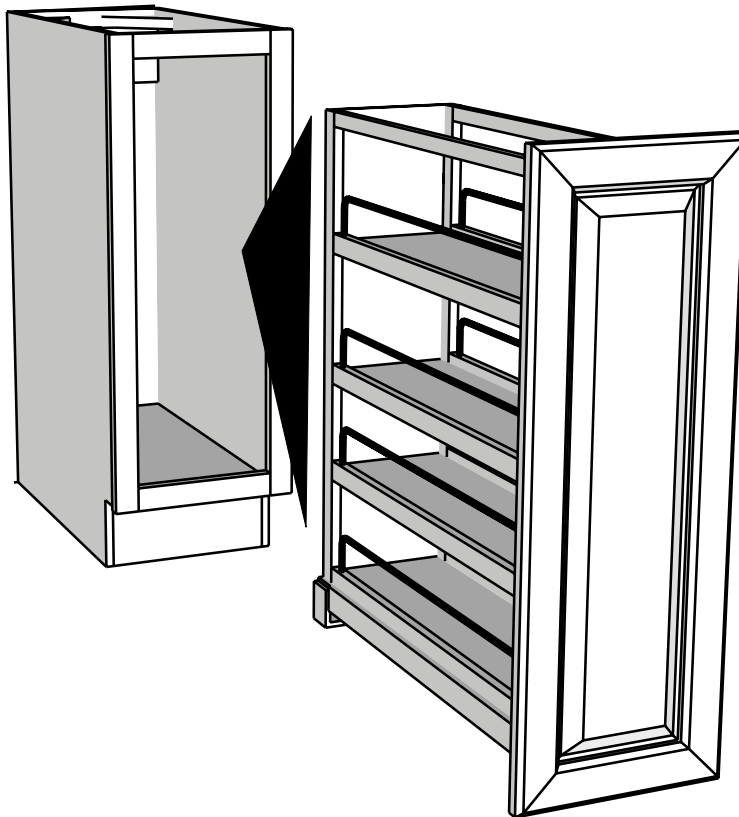

438 SERIES

WOOD BASE ORGANIZERS

- Designed for full height 6" and 9" base cabinets
- Fully assembled
- Adjustable shelves
- Beautiful maple construction with chrome accents
- Glides on 100 lb. full-extension ball-bearing slides
- Designed with top slide for complete stability
- Can be trimmed to 26-3/8" height for custom cabinet construction

NEW!



INSTALLED
WITHOUT DOOR

Our customers asked... so we delivered!

We took the best features of our 448 Series Base Organizers and our 432 Series Filler Organizers and created this product specifically for use in full height base 6 and 9 cabinets.

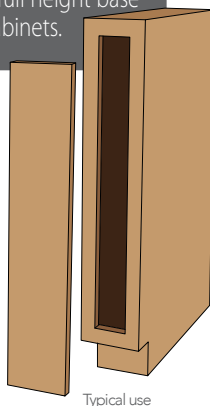

Typical use



STEP 1

INSTALL SHIMS IN THE
BOTTOM OF THE CABINET



STEP 2

INSERT UNIT



STEP 3

INSERT SCAB
(NOT INCLUDED)



STEP 4

ATTACH SCAB



STEP 5

REMOVE UNIT AND
ATTACH FRAME BOTTOM

PRODUCT #	DESCRIPTION	DIMENSIONS	MINIMUM OPENING	FINISH	SET PER CTN	WHT PER CARTON	SUGGESTED LIST PRICE
438-BC-3C	Base Organizer for Base 6	3" (76 mm)W x 23" (584 mm)D x 27 ⁵ / ₁₆ " (686 mm)H	3"	Wood	1	32 lb.	\$142.40
438-BC-6C	Base Organizer for Base 9	6" (153 mm)W x 23" (584 mm)D x 27 ⁵ / ₁₆ " (686 mm)H	6"	Wood	1	48 lb.	\$203.70

444 SERIES

PULLOUT BASE ORGANIZER

- Includes adjustable rub bushings
- Constructed from maple with a UV clear coat finish
- Designed for full-height Base 12" cabinets
- Features a magnetic grade stainless steel panel and an array of accessory hooks
- Door mounting is easy with our patented door mount brackets
- Brackets provide 5" of adjustability
- Additional accessory hooks can be purchased separately
- Non soft-close also available

See page 167 for wall version
(non soft-close)

SINK AND BASE
ACCESSORIES



REVERSIBLE

FEATURING **blum**
concealed runners with BLUMOTION soft-close



ADJUSTABLE RUB BUSHING!



ADJUSTABLE DOOR MOUNT BRACKET
US PATENT NO: 7,204,569

MICRO-ADJUSTMENT SCREW FOR
PRECISE DOOR ALIGNMENT



MAGNETIC GRADE
STAINLESS STEEL PANEL

PRODUCT #	DESCRIPTION	DIMENSIONS	FINISH	SET PER CTN	WHT PER CARTON	SUGGESTED LIST PRICE
Soft-Close Base Organizer (Individual Pack)						
444-BCSC-8SS	Base Organizer w/Stainless Steel Panel w/ Blum Soft-close	8" (203 mm)W x 21 1/8" (550 mm)D x 25 1/2" (648 mm)H	Wood/Stainless	1	33.3 lb.	\$501.85
Base Organizer (Individual Pack)						
444-BC-8SS	Base Organizer w/Stainless Steel Panel	8" (202 mm)W x 22 1/2" (569 mm)D x 25 1/2" (647 mm)H	Wood/Stainless	1	35 lb.	\$380.50

CONTAINS:

(1) Pullout System, Chrome Rail, 100 lb. Weight-Rated, Full-Extension Tri-Slides, Rub Bushings, and a variety of accessory pegs and hooks.

NOTE: Full height door base cabinet required. US PATENT NO: 7,204,569

448 SERIES

SOFT-CLOSE BASE ORGANIZER

All Units:

- Adjustable shelves with chrome rails
- Includes adjustable rub bushings
- Constructed from maple with a UV clear coat finish
- Door mounting is easy with our patented door mount brackets
- Brackets provide 5" of adjustability

Soft-Close Units:

- Soft-Close units slide on ball-bearing slides
- Designed for 9" and 12" full height face frame base cabinets.

Ball-Bearing Units:

- Feature our patented "tri-slides" which minimize any side-to-side motion (US Patent No. 7,306,301)
- Designed for 9", 12" and 15" full height face frame base cabinets, and 9" full height frameless cabinets

See page 166 for wall version



448-BCBSC-8C



PRODUCT #	DESCRIPTION	DIMENSIONS	FINISH	SET PER CTN	WHT PER CARTON	SUGGESTED LIST PRICE
Soft-Close Base Organizer (Individual Pack)						
448-BCBSC-5C	Base Organizer with Soft-Close	5" (127 mm)W x 21¾" (553 mm)D x 25½"-29½" (648-750 mm)H	Wood	1	25 lb.	\$233.75
448-BCBSC-8C	Base Organizer with Soft-close	8" (203 mm)W x 21¾" (553 mm)D x 25½"-29½" (648-750 mm)H	Wood	1	32 lb.	\$249.25
448-08SC-SRI-1	Spice Rack for Above	7" (178 mm)W x 19½" (534 mm)D x 4⅞" (124 mm)H	Wood	1	4 lb.	\$57.15
448-BC-14C	Base Organizer	See Detailed Specifications on Opposite Page	Wood	1	40.5 lb.	\$377.30

PRODUCT #	DESCRIPTION	DIMENSIONS	FINISH	SET PER CTN	WHT PER CARTON	SUGGESTED LIST PRICE
Base Organizer (Individual Pack)						
448-BC-5C	Base Organizer	See Detailed Specifications on Opposite Page	Wood	1	20 lb.	\$187.80
448-BC19-5C	Base Organizer (19" Depth)	5" (127 mm)W x 19" (483 mm) D x 25½" (647 mm)H	Wood	1	30 lb.	\$231.70
448-BC-6C	Frameless Organizer	See Detailed Specifications on Opposite Page	Wood	1	34 lb.	\$190.95
448-BC-8C	Base Organizer	See Detailed Specifications on Opposite Page	Wood	1	24 lb.	\$215.60
448-SR8-1	Spice Rack for Above	7" (178 mm)W x 21" (534 mm)D x 4⅞" (124 mm)H	Wood	1	5 lb.	\$44.50
448-BC19-8C	Base Organizer (19" Depth)	8" (203 mm)W x 19" (483 mm) D x 25½" (647 mm)H	Wood	1	29 lb.	\$325.95
448-BC-11C	Base Organizer	See Detailed Specifications on Opposite Page	Wood	1	41 lb.	\$331.05
448-SR11-1	Spice Rack for Above	10" (254 mm)W x 21" (534 mm)D x 4⅞" (124 mm)H	Wood	1	6 lb.	\$56.85
448-BC-14C	Base Organizer	See Detailed Specifications on Opposite Page	Wood	1	40.5 lb.	\$392.35
IDRB-1	Adjustable Rub Bushing for Inset Applications		Metal	1	1 lb.	\$12.65

CONTAINS: (1) Pullout Shelving System, 3 Adjustable Shelves with Chrome Rails, Full-Extension Tri-Slides, Rub Bushings. 11", 14" - 150 lb. Weight-Rated Slides 5", 6", 8" - 100 lb. Weight Rated Slides **NOTE:** Full height door base cabinet required. US PATENT NO: 7,204,569; 7,306,301



ADJUSTABLE REAR WALL



ADJUSTABLE SHELVES!



ADJUSTABLE DOOR MOUNT BRACKET
US PATENT NO: 7,204,569

MICRO-ADJUSTMENT SCREW FOR
PRECISE DOOR ALIGNMENT



ADJUSTABLE RUB BUSHING!

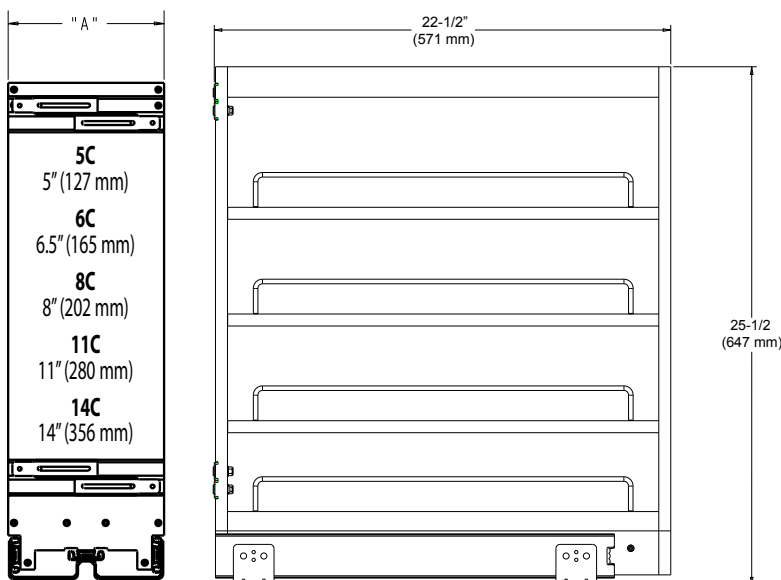

For Inset applications or for those who prefer to keep their cabinets flawless we recommend our IDR bushing. The discreet design prevents side to side movement and fits behind the frame eliminating the need for surface drilling giving you a seamless look and unparalleled stability.

448 SERIES

BLUM® SOFT-CLOSE BASE ORGANIZER

- Adjustable shelves with chrome rails
- Includes adjustable rub bushings
- Constructed from maple with a UV clear coat finish
- Door mounting is easy with our patented door mount brackets (US Patent No. 7,204,569)
- Brackets provide 5" of adjustability
- Full-extension BLUMOTION soft-close slides
- Designed for 9", 12", 15" and 18" full-height base cabinets



FEATURING



concealed runners with BLUMOTION
soft-close and SERVO-DRIVE



Product Part	Overall Width	Width Wood Pull-Out	Min Opening for FF	Min Opening Frameless	Depth	Height
448-BCSC-5C	5½" (140 mm)	5" (127 mm)	5½" (140 mm)	5½" (140 mm)	21½" (549 mm)	25½"-29½" (648-749 mm)
448-BCSC-8C	8" (203 mm)	8" (203 mm)	8½" (216 mm)	8½" (216 mm)	21½" (549 mm)	25½"-29½" (648-749 mm)
448-BCSC-11C	11" (280 mm)	11" (280 mm)	11½" (292 mm)	11½" (292 mm)	21½" (549 mm)	25½"-29½" (648-749 mm)
448-BCSC-14C	14" (356 mm)	14" (356 mm)	14½" (368 mm)	14½" (368 mm)	21½" (549 mm)	25½"-29½" (648-749 mm)
448-BCSC-6C	6½" (165 mm)	6½" (165 mm)	7" (178 mm)	7" (178 mm)	21½" (549 mm)	25½"-29½" (648-749 mm)
448-BCSC-9C	9½" (241 mm)	9½" (241 mm)	10" (254 mm)	10" (254 mm)	21½" (549 mm)	25½"-29½" (648-749 mm)
448-BCSCSD-5C	5½" (140 mm)	5" (127 mm)	5½" (140 mm)	5½" (140 mm)	22¾"-24¼" (578-616 mm)	25½"-29½" (648-749 mm)
448-BCSCSD-8C	8" (203 mm)	8" (203 mm)	8½" (216 mm)	8½" (216 mm)	22¾"-24¼" (578-616 mm)	25½"-29½" (648-749 mm)

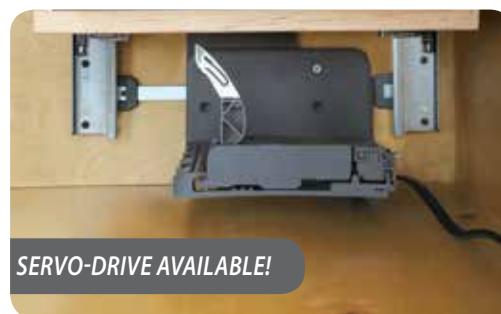

SERVO-DRIVE AVAILABLE!

PRODUCT #	DESCRIPTION	DIMENSIONS	FINISH	SET PER CTN	WHT PER CARTON	SUGGESTED LIST PRICE
Soft-Close Base Organizer (Individual Pack)						
448-BCSC-5C	Base Organizer w/Blum Soft-Close	See dimensions in the chart above.	Wood	1	24 lb.	\$280.60
448-BC19SC-5C	Base Organizer (19" Depth) w/Blum Soft-Close	6" (153 mm)W x 19½" (534 mm)D x 25½" (647 mm)H	Wood	1	30 lb.	\$283.75
448-BCSC-8C	Base Organizer w/Blum Soft-close	See dimensions in the chart above.	Wood	1	31 lb.	\$311.15
448-BC19SC-8C	Base Organizer (19" Depth) w/Blum Soft-Close	8½" (216 mm)W x 19" (483 mm) D x 25½" (647 mm)H	Wood	1	29 lb.	\$374.40
448-08SC-SRI-1	Spice Rack for Above	7" (178 mm)W x 19½" (534 mm)D x 4⅞" (124 mm)H	Wood	1	4 lb.	\$57.15
448-BCSC-11C	Base Organizer w/Blum Soft-Close	See dimensions in the chart above.	Wood	1	39 lb.	\$356.40
448-11SC-SRI-1	Spice Rack for Above	10" (254 mm)W x 19½" (534 mm)D x 4⅞" (124 mm)H	Wood	1	7 lb.	\$68.15
448-BCSC-14C	Base Organizer w/Blum Soft-Close	See dimensions in the chart above.	Wood	1	39 lb.	\$466.05
448-BCSC-6C	Base Organizer w/Blum Soft-Close for Frameless	See dimensions in the chart above.	Wood	1	27.25 lb.	\$297.70
448-BCSC-9C	Base Organizer w/Blum Soft-close for Frameless	See dimensions in the chart above.	Wood	1	34 lb.	\$352.95
448-BCSCSD-5C	Base Organizer w/Blum Soft-Close & Servo Drive	See dimensions in the chart above.	Wood	1	28 lb.	\$799.55
448-BCSCSD-8C	Base Organizer w/Blum Soft-close & Servo Drive	See dimensions in the chart above.	Wood	1	35 lb.	\$834.90
448-08SC-SRI-1	Spice Rack for Above	7" (178 mm)W x 19½" (534 mm)D x 4⅞" (124 mm)H	Wood	1	4 lb.	\$57.15



448OXO SERIES

OXO® CONTAINER BASE ORGANIZER

- Comes with OXO™ Good Grips POP containers (BPA Free)
- Includes adjustable rub bushings
- Constructed from maple with a UV clear coat finish
- Door mounting is easy with our patented door mount brackets (US Patent No. 7,204,569)
- Brackets provide 5" of adjustability
- Full-extension BLUMOTION soft-close slides
- Designed for 12" full-height base cabinets

SINK AND BASE
ACCESSORIES



PRODUCT #	DESCRIPTION	DIMENSIONS	FINISH	SET PER CTN	WHT PER CARTON	SUGGESTED LIST PRICE
Utensil Bin Base Organizer (Individual Pack)						
448OXO-BCSC-8C	8" Base Organizer with OXO® Containers	8½" (216 mm) W x 21½" (549 mm) D x 25½" (648 mm) H	Wood/Stainless	1	31 lb.	\$580.60

448UT SERIES

UTENSIL BIN BASE ORGANIZER

- Designed for full height 9" and 12" base cabinets
- Adjustable shelves
- Comes complete with 3 stainless steel bins
- Full-extension BLUMOTION soft-close slides
- Features Rev-A-Shelf's patented door mount brackets (US Patent No. 7,204,569)
- Comes with adjustable rub bushings that prevent side to side movement and frame rubbing
- Includes adjustable rear wall for extra strength and stability
- Sizes accommodate 5-1/2" (5C) and 8-1/2" (8C) minimum cabinet openings



448UT-BCSC-5C



448UT-BCSC-8C



448UT-BCSC-5C

PRODUCT #	DESCRIPTION	DIMENSIONS	FINISH	SET PER CTN	WHT PER CARTON	SUGGESTED LIST PRICE
Utensil Bin Base Organizer (Individual Pack)						
448UT-BCSC-5C	5" Base Organizer with 3 Bins for Utensils and Shelves	5½" (140 mm) W x 21½" (549 mm) D x 25½" (648 mm) H	Wood/Stainless	1	24 lb.	\$348.75
448UT-BCSC-8C	8" Base Organizer with 3 Bins for Utensils and Shelves	8" (203 mm) W x 21½" (549 mm) D x 25½" (648 mm) H	Wood/Stainless	1	32 lb.	\$398.75



448KB SERIES KNIFE BLOCK AND UTENSIL BASE ORGANIZER

- Designed for full height 15" base cabinets
- Adjustable shelf
- Stainless Steel bins and inserts are removable for cleaning
- Blum concealed runners with BLUMOTION soft-close
- Features Rev-A-Shelf's patented door mount brackets (US Patent No. 7,204,569)
- Comes with adjustable rub bushings that prevent side to side movement and frame rubbing
- Includes adjustable rear wall for extra strength and stability
- Knife inserts feature movable flex rods that adjust to hold a multitude of knives
- 8" base includes one 5-1/4" stainless steel bin
- 11" base includes two 5-1/4" and two 5" stainless steel bins

SINK AND BASE
ACCESSORIES



PRODUCT #	DESCRIPTION	DIMENSIONS	FINISH	SET PER CTN	WHT PER CARTON	SUGGESTED LIST PRICE
Knife Block and Utensil Bin Base Organizer (Individual Pack)						
448KB-BCSC-8C	8" Base Organizer with Knife Block/Bins/Shelf	8" (203 mm) W x 21 5/8" (549 mm) D x 25 1/2" (648 mm) H	Wood/Stainless	1	35 lb.	\$521.00
448KB-BCSC-11C	11" Base Organizer with Knife Block/Bins/Shelf	11" (280 mm) W x 21 5/8" (549 mm) D x 25 1/2" (648 mm) H	Wood/Stainless	1	53 lb.	\$626.70

447 SERIES

TRAY DIVIDER/FOIL WRAP HOLDER

- Designed for 9" and 12" base cabinets
- Door mounting is easy with our patented door mount brackets (US Patent No. 7,204,569)
- Brackets provide 5" of adjustability
- Available in non soft-close, ball-bearing soft-close and full-extension BLUMOTION soft-close slides
- Includes removable center divider
- Includes T-Bar divider for taller items

SINK AND BASE
ACCESSORIES



FEATURING
blum
concealed runners with BLUMOTION soft-close

PRODUCT #	DESCRIPTION	DIMENSIONS	FINISH	SET PER CTN	WHT PER CARTON	SUGGESTED LIST PRICE
Foil Wrap Holder (Individual Pack)						
447-BC-5C	5" Tray Divider/Foil Wrap Holder	See Detailed Specifications on Opposite Page	Wood	1	25 lb.	\$188.65
447-BC-8C	8" Tray Divider/Foil Wrap Holder	See Detailed Specifications on Opposite Page	Wood	1	32 lb.	\$249.55
Foil Wrap Holder with Soft-Close (Individual Pack)						
447-BCBSC-5C	5" Foil Wrap Holder/Tray Divider w/ Soft-Close	5" (127 mm)W x 21½" (546 mm)D x 19½" (495 mm)H	Wood	1	24 lb.	\$251.15
447-BCBSC-8C	8" Foil Wrap Holder/Tray Divider w/ Soft-Close	8" (203 mm)W x 21½" (546 mm)D x 19½" (495 mm)H	Wood	1	26 lb.	\$272.45
Foil Wrap Holder with Blum Soft-Close (Individual Pack)						
447-BCSC-5C	5" Foil Wrap Holder/Tray Divider w/ Blum Soft-Close	5" (127 mm)W x 21½" (546 mm)D x 19½" (495 mm)H	Wood	1	20 lb.	\$269.70
447-BCSC-8C	8" Foil Wrap Holder/Tray Divider w/ Blum Soft-Close	8" (203 mm)W x 21½" (546 mm)D x 19½" (495 mm)H	Wood	1	26 lb.	\$310.60



Tray Dividers slide in and out of the unit easily and can be adjusted to accommodate many different items



ADJUSTABLE DOOR MOUNT BRACKET
US PATENT NO: 7,204,569

Micro-Adjustment Screw for precise door alignment

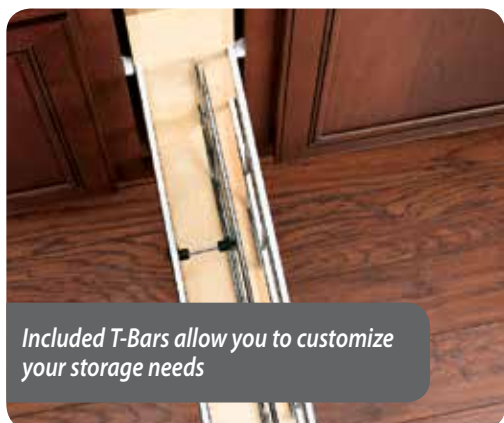

Included T-Bars allow you to customize your storage needs



Also available in ball-bearing soft-close and non soft-close!

SINK AND BASE
ACCESSORIES



Adjustable RUB BUSHING!



Product secured in cabinet with rear adjustable brackets

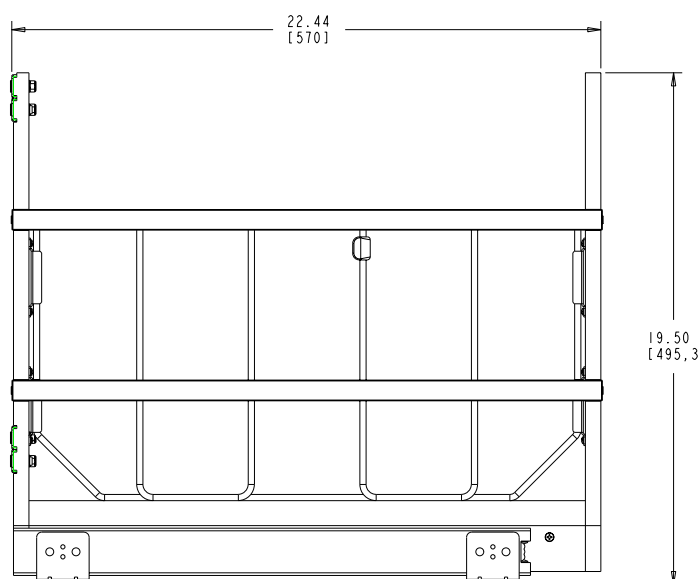
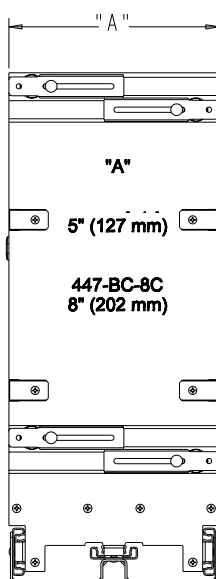

5322 SERIES

TWO-TIER BASE ORGANIZER

- Features soft-close full-extension progressive roller slides
- 90 lb. weight capacity
- Available in grey or maple shelving surfaces
- Base 9 organizers side-mount
- 8" and 11" base organizers bottom-mount
- Includes door mount brackets
- Three sizes accommodate 9", 11" and 15" face frame minimum cabinet openings



PRODUCT #	DESCRIPTION	DIMENSIONS	FINISH	SET PER CTN	WHT PER CARTON	SUGGESTED LIST PRICE
5322-4-GR	Two-Tier Base Organizer with Soft-Close	4¼" (108 mm)W x 19¾" (493 mm)D x 20½" (521 mm)H	Chrome/Grey	1	10 lb.	\$226.50
5322-4-MP	Two-Tier Base Organizer with Soft-Close	4¼" (108 mm)W x 19¾" (493 mm)D x 20½" (521 mm)H	Chrome/Maple	1	10 lb.	\$233.15
5322-11-GR	Two-Tier Base Organizer with Soft-Close	9" (251 mm)W x 19¾" (493 mm)D x 20¾" (523 mm)H	Chrome/Grey	1	15 lb.	\$296.40
5322-11-MP	Two-Tier Base Organizer with Soft-Close	9" (251 mm)W x 19¾" (493 mm)D x 20¾" (523 mm)H	Chrome/Maple	1	15 lb.	\$303.05
5322-16-GR	Two-Tier Base Organizer with Soft-Close	15¾" (403 mm)W x 19¾" (493 mm)D x 20¾" (523 mm)H	Chrome/Grey	1	19 lbs.	\$313.05
5322-16-MP	Two-Tier Base Organizer with Soft-Close	15¾" (403 mm)W x 19¾" (493 mm)D x 20¾" (523 mm)H	Chrome/Maple	1	19 lbs.	\$319.75
New Sizes Coming 2015						
5322-BC-5-GR	Grey Two-Tier Base Organizer w/SC for Base 9	6¼" (159 mm) W x 22¾" (568 mm) D x 21" (534 mm) H	Chrome/Grey	1	TBD	\$296.55
5322-BC-5-MP	Maple Two-Tier Base Organizer w/SC for Base 9	6¼" (159 mm) W x 22¾" (568 mm) D x 21" (534 mm) H	Chrome/Maple	1	TBD	\$303.20
5322-BC-8-GR	Grey Two-Tier Base Organizer w/SC for Base 12	8¾" (213 mm) W x 22¾" (568 mm) D x 21" (534 mm) H	Chrome/Grey	1	TBD	\$316.70
5322-BC-8-MP	Maple Two-Tier Base Organizer w/SC for Base 12	8¾" (213 mm) W x 22¾" (568 mm) D x 21" (534 mm) H	Chrome/Maple	1	TBD	\$323.35
5322-BC-11-GR	Grey Two-Tier Base Organizer w/SC for Base 15	11¾" (289 mm) W x 22¾" (568 mm) D x 21" (534 mm) H	Chrome/Grey	1	TBD	\$338.45
5322-BC-11-MP	Maple Two-Tier Base Organizer w/SC for Base 15	11¾" (289 mm) W x 22¾" (568 mm) D x 21" (534 mm) H	Chrome/Maple	1	TBD	\$345.10



5322KB SERIES KNIFE BLOCK AND UTENSIL BASE ORGANIZER

- Designed for 12" and 15" full height base cabinets
- Easy to clean removable Stainless Steel bin
- Full-extension progressive roller soft-close slides
- 90 lb. weight capacity
- Features Rev-A-Shelf's patented door mount brackets (US Patent No. 7,204,569)
- Knife inserts feature movable flex rods that adjust to hold a multitude of knives
- Stainless Steel bins and inserts are removable for cleaning
- 8" base includes one 5-1/4" stainless steel bin
- 11" base includes two 5-1/4" and two 5" stainless steel bins

SINK AND BASE
ACCESSORIES



COMING SUMMER OF 2015!



PRODUCT #	DESCRIPTION	DIMENSIONS	FINISH	SET PER CTN	WHT PER CARTON	SUGGESTED LIST PRICE
5322KB-BC-8-GR	Grey 8" Base Organizer with Knife Block/Bins/Shelf	8 3/8" (213 mm) W x 22 3/8" (568 mm) D x 21" (534 mm) H	Chrome/Grey	1	TBD	TBD
5322KB-BC-8-MP	Maple 8" Base Organizer with Knife Block/Bins/Shelf	8 3/8" (213 mm) W x 22 3/8" (568 mm) D x 21" (534 mm) H	Chrome/Maple	1	TBD	TBD
5322KB-BC-11-GR	Grey 11" Base Organizer with Knife Block/Bins/Shelf	11 3/8" (289 mm) W x 22 3/8" (568 mm) D x 21" (534 mm) H	Chrome/Grey	1	TBD	TBD
5322KB-BC-11-MP	Maple 11" Base Organizer with Knife Block/Bins/Shelf	11 3/8" (289 mm) W x 22 3/8" (568 mm) D x 21" (534 mm) H	Chrome/Maple	1	TBD	TBD

5375 SERIES WINE BASE ORGANIZER WITH SOFT-CLOSE

- Holds twenty wine bottles
- Universal for left or right handed cabinets
- Patented AMB door mount brackets that allow up to 5" of adjustability (US Patent No. 7,204,569)
- Gas Spring Assist Soft-Open/Soft-Close
- Designed to accommodate a 15" minimum cabinet opening





NOTE: WEIGHT CAPACITY
PER SHELF IS 75 LB.

Minimum Opening

5375-40WR-1CR	15" (381mm)
---------------	-------------



INCLUDES 5 WINERACKS
STORES UP TO 20 BOTTLES!

PRODUCT #	DESCRIPTION	DIMENSIONS	FINISH	SET PER CTN	WHT PER CARTON	SUGGESTED LIST PRICE
Wine Base Organizer with Soft-Close (Individual Pack)						
5375-40WR-1CR	Wine Base Organizer with Soft-Close	14 $\frac{1}{8}$ " (356 mm)W x 17" (432 mm)D x 25 $\frac{3}{4}$ " (654 mm)H	Chrome	1	30 lb.	\$623.50

5786 SERIES PULLOUT U-SHAPED WIRE BASKET

SINK AND BASE
ACCESSORIES



CONTAINS 1 BASKET, TWO UNITS SHOWN

- Unique U-Shaped frame fits around the peskiest of pipes
- Comes in two sizes to accommodate 33" and 36" sink base cabinets
- Features soft-close full-extension slides
- Provides easy access to stored items
- Bottom and side mount brackets included





PRODUCT #	DESCRIPTION	DIMENSIONS	FINISH	SET PER CTN	WHT PER CARTON	SUGGESTED LIST PRICE
Pullout U-Shaped Wire Basket (Individual Pack)						
5786-30CR	Undersink Pull Out w/ Soft-Close	29½" (746 mm) - 31¾" (807 mm)W x 22" (557 mm)D x 5¼" (132 mm)H	Chrome	1	15 lb.	\$239.10
5786-33CR	Undersink Pull Out w/ Soft-Close	32½" (822 mm) - 34¾" (883 mm)W x 22" (557 mm)D x 5¼" (132 mm)H	Chrome	1	16.5 lb.	\$248.10

5730 SERIES

PREMIERE PULLOUT SHELVES

- Available in four sizes
- Full-extension under-mount soft-close slides
- Adjustable mounting brackets
- Our patented door mount brackets are also included

SINK AND BASE
ACCESSORIES



Side Mounting Dimensions

PART	DESCRIPTION	Width Min. (L)	Width Max. (L1)
5730-12CR	12" Pull Out Wire Baskets w/ Soft-Close	11-5/16" (287mm)	13-11/16" (348mm)
5730-15CR	15" Pull Out Wire Baskets w/ Soft-Close	14-5/16" (364mm)	16-11/16" (424mm)
5730-21CR	21" Pull Out Wire Baskets w/ Soft-Close	20-5/16" (516 mm)	22-11/16" (576mm)
5730-33CR	33" Pull Out Wire Baskets w/ Soft-Close	32-3/8" (822 mm)	34-3/4" (882 mm)

PRODUCT #	DESCRIPTION	DIMENSIONS	FINISH	SET PER CTN	WHT PER CARTON	SUGGESTED LIST PRICE
Premiere Pullout Shelves (Individual Pack)						
5730-12CR	12" Pull Out Wire Baskets w/ Soft-Close	See Drawings on Next Page	Chrome	1	10.5 lb.	\$214.90
5730-15CR	15" Pull Out Wire Baskets w/ Soft-Close	See Drawings on Next Page	Chrome	1	13.25 lb.	\$224.90
5730-21CR	21" Pull Out Wire Baskets w/ Soft-Close	See Drawings on Next Page	Chrome	1	18.5 lb.	\$248.25
5730-33CR	33" Pull Out Wire Baskets w/ Soft-Close	See Drawings on Next Page	Chrome	1	29 lb.	\$272.90
5789CR	Drop In Cookware Organizer	14 1/8" (357mm)W x 9 1/2" (241mm)D x 7 1/8" (195 mm)H	Chrome	1	2 lb.	\$38.70

Create a customized space for pots, pans and lids with the new Chrome Wire Drop In Cookware Organizer, compatible with 15", 21", and 33" pullout baskets

5789CR



SINK AND BASE
ACCESSORIES

TOP VIEW

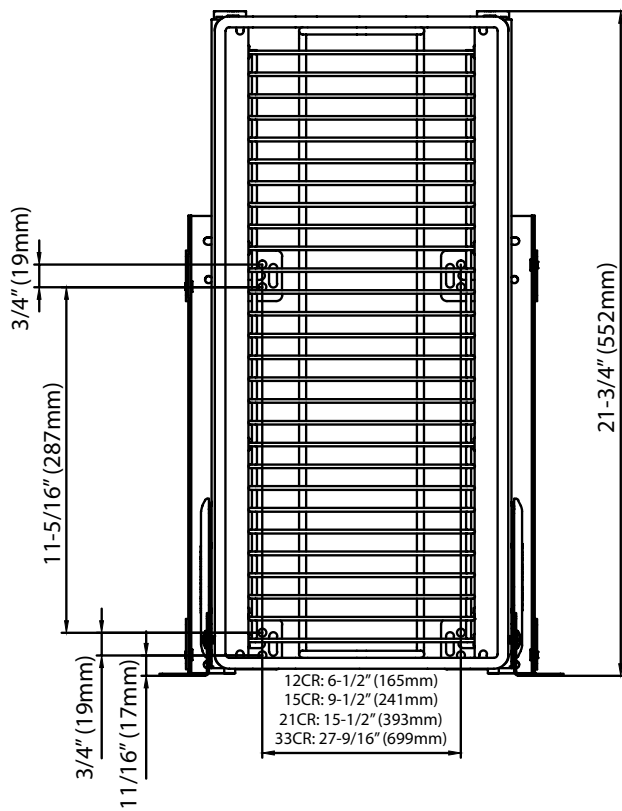

FRONT VIEW

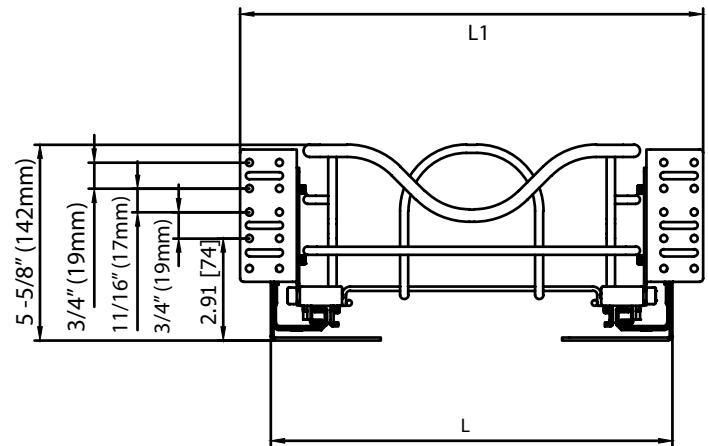

SIDE VIEW

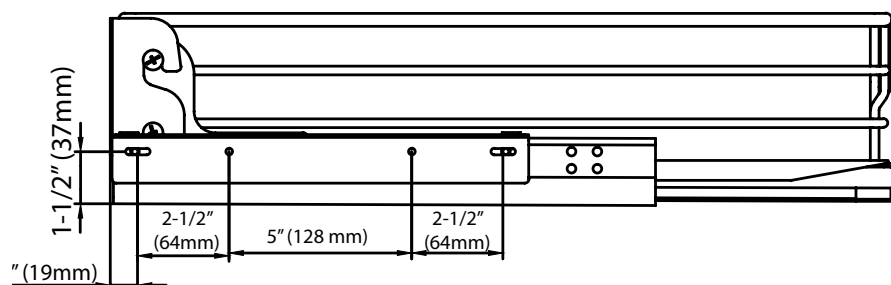

5330 MP SERIES

MAPLE PULLOUT BASKET

SINK AND BASE
ACCESSORIES



5330-15-MP

CONTAINS 1 BASKET, TWO UNITS SHOWN

COMPAGNUCCI
QUALITY MADE IN ITALY

- Can be side or bottom mounted
- Features soft-close full-extension slides
- Door mounting brackets are also included
- Feature chrome plated wire fencing and Stylinox™ Anti-Skid surfaces
- Designed for 18", 24" and 36" Base Cabinets



FEATURING STYLINOX™
ANTI-SKID SURFACE

PRODUCT #	DESCRIPTION	DIMENSIONS	FINISH	SET PER CTN	WHT PER CARTON	SUGGESTED LIST PRICE
Maple Pull-Out Basket (Individual Pack)						
5330-15-MP	15" Pullout Basket	14 3/8" (365 mm)W x 22 1/8" (562 mm)D x 7 1/2" (190 mm)H	Maple/Chrome	1	19 lb.	\$435.60
5330-21-MP	21" Pullout Basket	20 3/8" (517 mm)W x 22 1/8" (562 mm)D x 7 1/2" (190 mm)H	Maple/Chrome	1	22 lb.	\$474.60
5330-33-MP	33" Pullout Basket	32 3/8" (822 mm)W x 22 1/8" (562 mm)D x 7 1/2" (190 mm)H	Maple/Chrome	1	29 lb.	\$525.20

5225 MP SERIES PULLOUT MAPLE PANTRY

- Available in three heights and two widths
- Feature adjustable maple shelves with Stylinox™, an Anti-Skid transparent coating
- 250 lb. rated soft-closing slide
- Door mountable
- Kit packaged.
- See page 122 for tall/pantry version

SINK AND BASE
ACCESSORIES



PRODUCT DIMENSIONS					
PART #	WIDTH	DEPTH	HEIGHT (MIN)	HEIGHT (MAX)	BASKETS
5225-09-MP	8 ⁵ / ₈ " (219 mm)	19 ¹ / ₂ " (495 mm)	26 ³ / ₄ " (680 mm)	35" (890 mm)	3
5258-09-MP	8 ⁵ / ₈ " (219 mm)	19 ¹ / ₂ " (495 mm)	59 ¹ / ₂ " (1510 mm)	66 ⁵ / ₈ " (1700 mm)	5
5258-14-MP	14 ¹ / ₂ " (369 mm)	19 ¹ / ₂ " (495 mm)	59 ¹ / ₂ " (1510 mm)	66 ⁵ / ₈ " (1700 mm)	5
5273-09-MP	8 ⁵ / ₈ " (219 mm)	19 ¹ / ₂ " (495 mm)	74 ⁷ / ₈ " (1900 mm)	81 ⁷ / ₈ " (2080 mm)	6
5273-14-MP	14 ¹ / ₂ " (369 mm)	19 ¹ / ₂ " (495 mm)	74 ⁷ / ₈ " (1900 mm)	81 ⁷ / ₈ " (2080 mm)	6

Individual Baskets Dimensions:

Width = Net Minimum Width from chart

Depth = 17-1/4" (439 mm), Height = 3" (77 mm)

PRODUCT #	DESCRIPTION	BASKET WIDTH	FRAME HEIGHT	OVERALL DEPTH	FINISH	SET PER CTN	WHT PER CARTON	SUGGESTED LIST PRICE
Maple "SHORTY" Pull-Out Pantry (Individual Pack)								
5225-09-MP	3 Baskets/2 Door Mount Brackets	8 ⁵ / ₈ " (226 mm)	26 ³ / ₈ "-35" (670-890 mm)	20" (508 mm)	Maple/Chrome	1	32 lb.	\$1,022.10

NOTE: All pantry kits are packaged with frame, baskets, and door mounting brackets in one carton. 250 lb. rated Full-Extension slides. (See above for more information.) First basket mounts on top of the slide, 6" (152 mm) from floor, holes then available every 4" (102 mm) above that.



548 SERIES

CHROME BASE ORGANIZER

- Slides smoothly on our patented Tri-Slide system
- Features ball-bearing slides
- Two adjustable Polymer Shelves
- Can be used in both full height or Door/Drawer Applications
- Includes our patented door mounting System
US PATENT NO: 7,204,569

SINK AND BASE
ACCESSORIES



PRODUCT #	DESCRIPTION	DIMENSIONS	FINISH	SET PER CTN	WHT PER CARTON	SUGGESTED LIST PRICE
Chrome Base Organizer (Individual Pack)						
548-BC-8C	Chrome Base Organizer	7 ⁷ / ₈ " (200 mm) W x 22 ¹ / ₂ " (572 mm) D x 19 ¹ / ₄ " (489 mm) H	Chrome	1	8 lb.	\$160.35

RAS-ML SERIES

HEAVY DUTY MIXER LIFT

- Can be attached to any custom made shelf and fits all cabinet sizes
- Provides mechanical assist
- Features built-in shock dampeners
- Now available with soft-close!
- Adjustable spring tension and holds appliances up to 60 lb.

SINK AND BASE
ACCESSORIES



SOFT-CLOSE VERSION
COMING SUMMER OF 2015!

PRODUCT #	DESCRIPTION	DIMENSIONS	FINISH	SET PER CTN	WHT PER CARTON	SUGGESTED LIST PRICE
Heavy-Duty Mixer Lift (Individual Pack)						
RAS-ML-HDCR	Heavy Duty Mixer Lift	See Illustrations Next page	Silver Powder Coat	1	15 lb.	\$164.85
Soft-Close Heavy-Duty Mixer Lift (Individual Pack)						
RAS-ML-HDSC	Soft-Close Heavy Duty Mixer Lift	See Illustrations Next page	Silver Powder Coat	1	15 lb.	\$280.85

NOTE: Needs to be installed in full height base cabinet. Provides mechanical assistance.
CONTAINS: Right and Left Lifting arms, Hardware. **SHELF NOT INCLUDED.**

Typical Cabinet PRODUCT DIMENSIONS

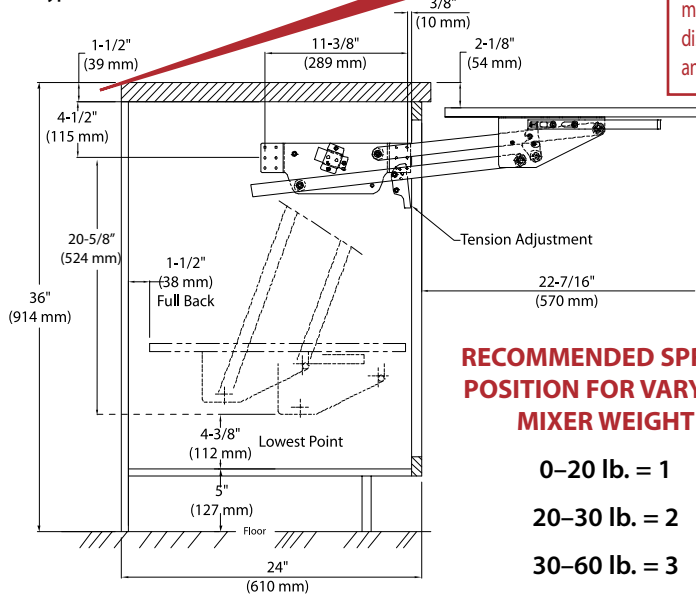

NOTE: The dimensions listed provide clearance for an item 15¹³/₁₆" H x 14¹/₄" D placed at the front edge of the shelf. Depending on your cabinet construction and your specific height and depth requirements, the 4¹/₂" dimension from the top of the cabinet to the middle of the lifting mechanism can be reduced to allow the platform to be closer to counter height, thus a greater distance below the unit in the closed position. It can also be increased to allow for items taller and deeper than the dimensions provided.

RECOMMENDED SPRING POSITION FOR VARYING MIXER WEIGHT

0-20 lb. = 1

20-30 lb. = 2

30-60 lb. = 3

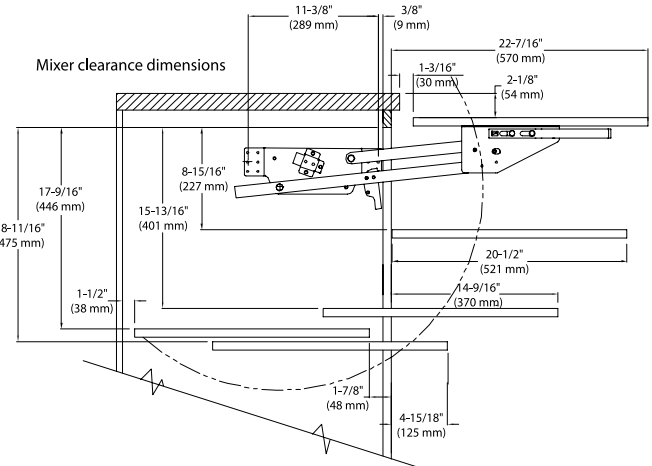

SINK AND BASE ACCESSORIES



SOFT-CLOSE PISTON!

To determine shelf size measure the distance between mounting plates when installed minus 1¹/₄".
Recommended length of shelf is 20¹/₂".
Mounting plates are 1" wide.



SHELF NOT INCLUDED



GREAT FOR A VARIETY OF SMALL APPLIANCES!